

3座A7: 2房 439'		
樓層	訂價	折實價17%
1	\$5,461,000 @\$12,440	\$4,532,630 @\$10,325
2	\$5,608,000 @\$12,774	\$4,654,640 @\$10,603
3	\$5,648,000 @\$12,866	\$4,687,840 @\$10,678
5	\$5,687,000 @\$12,954	\$4,720,210 @\$10,752
6	\$5,726,000 @\$13,043	\$4,752,580 @\$10,826
7	\$5,786,000 @\$13,180	\$4,802,380 @\$10,939
8	\$5,886,000 @\$13,408	\$4,885,380 @\$11,128
9	\$5,946,000 @\$13,544	\$4,935,180 @\$11,242
10	\$6,008,000 @\$13,686	\$4,986,640 @\$11,359
11	\$6,112,000 @\$13,923	\$5,072,960 @\$11,556

第3座 Tower 3

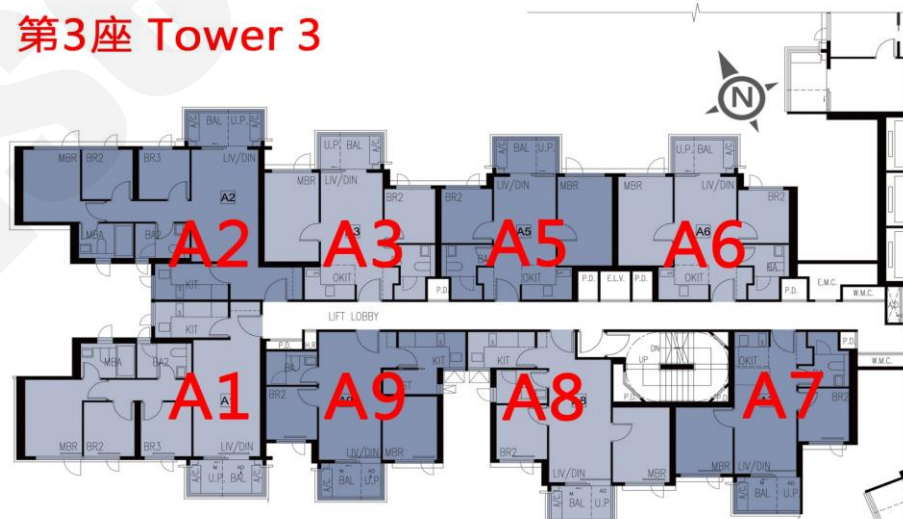

3座A8: 2房 474/475'		
樓層	訂價	折實價17%
1	\$6,078,000 @\$12,796	\$5,044,740 @\$10,621
2	\$6,243,000 @\$13,143	\$5,181,690 @\$10,909
3	\$6,286,000 @\$13,234	\$5,217,380 @\$10,984
5	\$6,330,000 @\$13,326	\$5,253,900 @\$11,061
6	\$6,374,000 @\$13,419	\$5,290,420 @\$11,138
7	\$6,419,000 @\$13,514	\$5,327,770 @\$11,216
8	\$6,509,000 @\$13,703	\$5,402,470 @\$11,374
9	\$6,555,000 @\$13,800	\$5,440,650 @\$11,454
10	\$6,601,000 @\$13,897	\$5,478,830 @\$11,534
11	\$6,679,000 @\$14,091	\$5,543,570 @\$11,695

第3座 Tower 3



3座C5: 1房 304'		
樓層	訂價	折實價17%
1	\$3,985,000 @\$13,109	\$3,307,550 @\$10,880
2	\$4,092,000 @\$13,461	\$3,396,360 @\$11,172
3	\$4,121,000 @\$13,556	\$3,420,430 @\$11,251
5	\$4,150,000 @\$13,651	\$3,444,500 @\$11,331
6	\$4,179,000 @\$13,747	\$3,468,570 @\$11,410
7	\$4,208,000 @\$13,842	\$3,492,640 @\$11,489
8	\$4,267,000 @\$14,036	\$3,541,610 @\$11,650
9	\$4,297,000 @\$14,135	\$3,566,510 @\$11,732
10	\$4,326,000 @\$14,230	\$3,590,580 @\$11,811
11	\$4,387,000 @\$14,431	\$3,641,210 @\$11,978

3座A9: 2房 473'		
樓層	訂價	折實價17%
2	\$6,367,000 @\$13,461	\$5,284,610 @\$11,173
3	\$6,412,000 @\$13,556	\$5,321,960 @\$11,252
5	\$6,457,000 @\$13,651	\$5,359,310 @\$11,330
6	\$6,502,000 @\$13,746	\$5,396,660 @\$11,409

紅色為最高售價、最高平均呎價；藍色為最低售價、最低平均呎價

5座A1 : 2房 435'		
樓層	訂價	折實價17%
1	\$5,261,000 @\$12,094	\$4,366,630 @\$10,038

5座A2 : 1房 304'		
樓層	訂價	折實價17%
2	\$3,979,000 @\$13,089	\$3,302,570 @\$10,864
3	\$4,150,000 @\$13,651	\$3,444,500 @\$11,331
5	\$4,162,000 @\$13,691	\$3,454,460 @\$11,363
6	\$4,174,000 @\$13,730	\$3,464,420 @\$11,396
7	\$4,204,000 @\$13,829	\$3,489,320 @\$11,478
8	\$4,262,000 @\$14,020	\$3,537,460 @\$11,636
9	\$4,292,000 @\$14,118	\$3,562,360 @\$11,718
10	\$4,322,000 @\$14,217	\$3,587,260 @\$11,800
11	\$4,353,000 @\$14,319	\$3,612,990 @\$11,885
12	\$4,414,000 @\$14,520	\$3,663,620 @\$12,051

5座A6 : 2房 440'		
樓層	訂價	折實價17%
2	\$5,465,000 @\$12,420	\$4,535,950 @\$10,309
3	\$5,481,000 @\$12,457	\$4,549,230 @\$10,339

5座A7 : 2房 437'		
樓層	訂價	折實價17%
2	\$5,381,000 @\$12,314	\$4,466,230 @\$10,220
3	\$5,419,000 @\$12,400	\$4,497,770 @\$10,292
5	\$5,701,000 @\$13,046	\$4,731,830 @\$10,828
6	\$5,854,000 @\$13,396	\$4,858,820 @\$11,119
7	\$5,896,000 @\$13,492	\$4,893,680 @\$11,198
8	\$5,978,000 @\$13,680	\$4,961,740 @\$11,354
9	\$6,020,000 @\$13,776	\$4,996,600 @\$11,434
10	\$6,062,000 @\$13,872	\$5,031,460 @\$11,514
11	\$6,104,000 @\$13,968	\$5,066,320 @\$11,593
12	\$6,190,000 @\$14,165	\$5,137,700 @\$11,757

第5座 Tower 5



5座A8 : 2房 424'		
樓層	訂價	折實價17%
2	\$5,291,000 @\$12,479	\$4,391,530 @\$10,357
3	\$5,328,000 @\$12,566	\$4,422,240 @\$10,430
5	\$5,606,000 @\$13,222	\$4,652,980 @\$10,974
6	\$5,756,000 @\$13,575	\$4,777,480 @\$11,268
7	\$5,797,000 @\$13,672	\$4,811,510 @\$11,348
8	\$5,878,000 @\$13,863	\$4,878,740 @\$11,506
9	\$5,919,000 @\$13,960	\$4,912,770 @\$11,587
10	\$5,961,000 @\$14,059	\$4,947,630 @\$11,669
11	\$6,002,000 @\$14,156	\$4,981,660 @\$11,749
12	\$6,086,000 @\$14,354	\$5,051,380 @\$11,914

5座B6 : 開放式 246'		
樓層	訂價	折實價17%
2	\$3,613,000 @\$14,687	\$2,998,790 @\$12,190
3	\$3,712,000 @\$15,089	\$3,080,960 @\$12,524
5	\$3,737,000 @\$15,191	\$3,101,710 @\$12,609
6	\$3,763,000 @\$15,297	\$3,123,290 @\$12,696
7	\$3,790,000 @\$15,407	\$3,145,700 @\$12,787
8	\$3,843,000 @\$15,622	\$3,189,690 @\$12,966
9	\$3,869,000 @\$15,728	\$3,211,270 @\$13,054
10	\$3,897,000 @\$15,841	\$3,234,510 @\$13,148
11	\$3,924,000 @\$15,951	\$3,256,920 @\$13,240
12	\$3,979,000 @\$16,175	\$3,302,570 @\$13,425

5座B1 : 3房 566'		
樓層	訂價	折實價17%
2	\$8,337,000 @\$14,730	\$6,919,710 @\$12,226
3	\$8,562,000 @\$15,127	\$7,106,460 @\$12,556

紅色為最高售價、最高平均呎價；藍色為最低售價、最低平均呎價

以最高17%折扣計算
制作日期: 2025-08-01

5座D1: 3房 715'		
樓層	訂價	折實價17%
2	\$9,989,000 @\$13.971	\$8,290,870 @\$11,596
3	\$10,059,000 @\$14,069	\$8,348,970 @\$11,677
5	\$10,581,000 @\$14,799	\$8,782,230 @\$12,283
6	\$10,920,000 @\$15,273	\$9,063,600 @\$12,676

5座D10:1房 303'		
樓層	訂價	折實價17%
2	\$3,800,000 @\$12,541	\$3,154,000 @\$10,409
3	\$3,826,000 @\$12,627	\$3,175,580 @\$10,480
	\$4,062,000 @\$13,406	\$3,371,460 @\$11,127
6	\$4,193,000 @\$13,838	\$3,480,190 @\$11,486
7	\$4,222,000 @\$13,934	\$3,504,260 @\$11,565
8	\$4,281,000 @\$14,129	\$3,553,230 @\$11,727
9	\$4,312,000 @\$14,231	\$3,578,960 @\$11,812
10	\$4,342,000 @\$14,330	\$3,603,860 @\$11,894
11	\$4,372,000 @\$14,429	\$3,628,760 @\$11,976
12	\$4,433,000 @\$14,630	\$3,679,390 @\$12,143



5座D11: 1房 304'		
樓層	訂價	折實價17%
2	\$3,602,000 @ \$11,849	\$2,988,660 @ \$9,834
3	\$3,627,000 @ \$11,931	\$3,010,410 @ \$9,903
	\$3,853,000 @ \$12,674	\$3,197,990 @ \$10,520
6	\$3,975,000 @ \$13,076	\$3,299,250 @ \$10,853
7	\$4,003,000 @ \$13,168	\$3,322,490 @ \$10,929
8	\$4,060,000 @ \$13,355	\$3,369,800 @ \$11,085
9	\$4,089,000 @ \$13,451	\$3,393,870 @ \$11,164
10	\$4,116,000 @ \$13,539	\$3,416,280 @ \$11,238
11	\$4,145,000 @ \$13,635	\$3,440,350 @ \$11,317
12	\$4,203,000 @ \$13,826	\$3,488,490 @ \$11,475

5座D9：1房 303'		
樓層	訂價	折實價17%
2	\$3,821,000 @\$12,611	\$3,171,430 @\$10,467
3	\$3,848,000 @\$12,700	\$3,193,840 @\$10,541
5	\$4,085,000 @\$13,482	\$3,390,550 @\$11,190
6	\$4,216,000 @\$13,914	\$3,499,280 @\$11,549
7	\$4,246,000 @\$14,013	\$3,524,180 @\$11,631
8	\$4,306,000 @\$14,211	\$3,573,980 @\$11,795
9	\$4,336,000 @\$14,310	\$3,598,880 @\$11,877
10	\$4,366,000 @\$14,409	\$3,623,780 @\$11,960
11	\$4,397,000 @\$14,512	\$3,649,510 @\$12,045
12	\$4,459,000 @\$14,716	\$3,700,970 @\$12,214