

Grand Seasons

價單1號

以最高12%折扣計算  
制作日期: 2025-01-07

Tower1(1A) Tower1(1B)

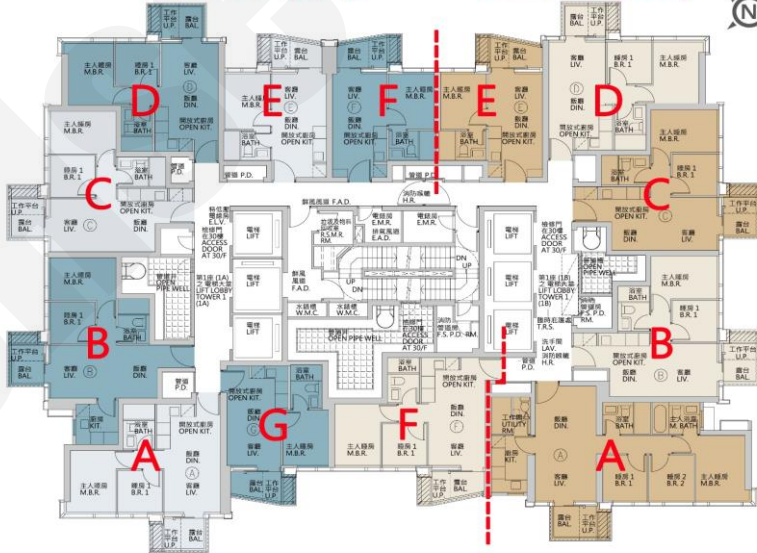

第1座(1A) C : 2房 453'		
樓層	訂價	折實價12%
8	\$7,201,000 @\$15,896	\$6,336,880 @\$13,989
9	\$7,216,000 @\$15,929	\$6,350,080 @\$14,018
12	\$7,259,000 @\$16,024	\$6,387,920 @\$14,101
15	\$7,274,000 @\$16,057	\$6,401,120 @\$14,131
16	\$7,296,000 @\$16,106	\$6,420,480 @\$14,173
18	\$7,335,000 @\$16,192	\$6,454,800 @\$14,249
19	\$7,348,000 @\$16,221	\$6,466,240 @\$14,274
23	\$7,388,000 @\$16,309	\$6,501,440 @\$14,352
25	\$7,401,000 @\$16,338	\$6,512,880 @\$14,377
26	\$7,415,000 @\$16,369	\$6,525,200 @\$14,404
27	\$7,428,000 @\$16,397	\$6,536,640 @\$14,430
28	\$7,455,000 @\$16,457	\$6,560,400 @\$14,482
29	\$7,468,000 @\$16,486	\$6,571,840 @\$14,507
30	\$7,482,000 @\$16,517	\$6,584,160 @\$14,535
31	\$7,493,000 @\$16,541	\$6,593,840 @\$14,556
32	\$7,506,000 @\$16,570	\$6,605,280 @\$14,581
33	\$7,520,000 @\$16,600	\$6,617,600 @\$14,608
35	\$7,533,000 @\$16,629	\$6,629,040 @\$14,634
36	\$7,547,000 @\$16,660	\$6,641,360 @\$14,661
37	\$7,561,000 @\$16,691	\$6,653,680 @\$14,688
38	\$7,588,000 @\$16,751	\$6,677,440 @\$14,740
41	\$7,629,000 @\$16,841	\$6,713,520 @\$14,820
42	\$7,643,000 @\$16,872	\$6,725,840 @\$14,847
45	\$7,670,000 @\$16,932	\$6,749,600 @\$14,900
46	\$7,684,000 @\$16,962	\$6,761,920 @\$14,927

第1座(1A) E : 1房 286/323'		
樓層	訂價	折實價12%
8	\$6,027,000 @\$21,073	\$5,303,760 @\$18,548
9	\$5,148,000 @\$15,938	\$4,530,240 @\$14,026
12	\$5,179,000 @\$16,034	\$4,557,520 @\$14,110
15	\$5,189,000 @\$16,065	\$4,566,320 @\$14,137
16	\$5,238,000 @\$16,217	\$4,609,440 @\$14,271
18	\$5,267,000 @\$16,307	\$4,634,960 @\$14,350
19	\$5,276,000 @\$16,334	\$4,642,880 @\$14,374
23	\$5,305,000 @\$16,424	\$4,668,400 @\$14,453
25	\$5,314,000 @\$16,452	\$4,676,320 @\$14,478
28	\$5,353,000 @\$16,573	\$4,710,640 @\$14,584
29	\$5,362,000 @\$16,601	\$4,718,560 @\$14,609
32	\$5,391,000 @\$16,690	\$4,744,080 @\$14,688
33	\$5,401,000 @\$16,721	\$4,752,880 @\$14,715
35	\$5,411,000 @\$16,752	\$4,761,680 @\$14,742
36	\$5,420,000 @\$16,780	\$4,769,600 @\$14,767
37	\$5,430,000 @\$16,811	\$4,778,400 @\$14,794
38	\$5,443,000 @\$16,851	\$4,789,840 @\$14,829
41	\$5,463,000 @\$16,913	\$4,807,440 @\$14,884
42	\$5,469,000 @\$16,932	\$4,812,720 @\$14,900
45	\$5,483,000 @\$16,975	\$4,825,040 @\$14,938
46	\$5,489,000 @\$16,994	\$4,830,320 @\$14,955

第1座(1A) B : 2房 495'		
樓層	訂價	折實價12%
9	\$8,074,000 @\$16,311	\$7,105,120 @\$14,354
12	\$8,123,000 @\$16,410	\$7,148,240 @\$14,441
15	\$8,139,000 @\$16,442	\$7,162,320 @\$14,469
16	\$8,175,000 @\$16,515	\$7,194,000 @\$14,533
18	\$8,219,000 @\$16,604	\$7,232,720 @\$14,612
19	\$8,234,000 @\$16,634	\$7,245,920 @\$14,638
23	\$8,279,000 @\$16,725	\$7,285,520 @\$14,718
25	\$8,294,000 @\$16,756	\$7,298,720 @\$14,745
28	\$8,353,000 @\$16,875	\$7,350,640 @\$14,850
29	\$8,369,000 @\$16,907	\$7,364,720 @\$14,878
32	\$8,411,000 @\$16,992	\$7,401,680 @\$14,953
33	\$8,426,000 @\$17,022	\$7,414,880 @\$14,980
35	\$8,442,000 @\$17,055	\$7,428,960 @\$15,008
36	\$8,457,000 @\$17,085	\$7,442,160 @\$15,035
37	\$8,472,000 @\$17,115	\$7,455,360 @\$15,061
38	\$8,502,000 @\$17,176	\$7,481,760 @\$15,115
41	\$8,548,000 @\$17,269	\$7,522,240 @\$15,196
42	\$8,564,000 @\$17,301	\$7,536,320 @\$15,225
45	\$8,595,000 @\$17,364	\$7,563,600 @\$15,280
46	\$8,610,000 @\$17,394	\$7,576,800 @\$15,307

紅色為最高售價、最高平均呎價；藍色為最低售價、最低平均呎價

Tower1(1A) Tower1(1B)

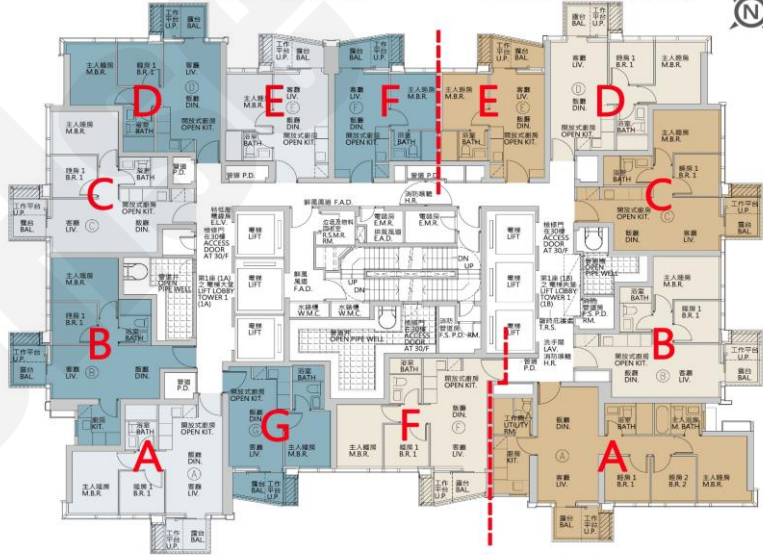

第1座(1B) A : 3房 678'716'		
樓層	訂價	折實價12%
8	\$13,104,000 @\$19,327	\$11,531,520 @\$17,008
9	\$12,290,000 @\$17,165	\$10,815,200 @\$15,105
15	\$12,389,000 @\$17,303	\$10,902,320 @\$15,227
16	\$12,469,000 @\$17,415	\$10,972,720 @\$15,325
18	\$12,536,000 @\$17,508	\$11,031,680 @\$15,407
19	\$12,559,000 @\$17,541	\$11,051,920 @\$15,436
23	\$12,627,000 @\$17,635	\$11,111,760 @\$15,519
25	\$12,649,000 @\$17,666	\$11,131,120 @\$15,546
28	\$12,741,000 @\$17,795	\$11,212,080 @\$15,659
29	\$12,764,000 @\$17,827	\$11,232,320 @\$15,688

第1座(1B) B : 2房 457'		
樓層	訂價	折實價12%
9	\$7,443,000 @\$16,287	\$6,549,840 @\$14,332
12	\$7,488,000 @\$16,385	\$6,589,440 @\$14,419
15	\$7,503,000 @\$16,418	\$6,602,640 @\$14,448
16	\$7,526,000 @\$16,468	\$6,622,880 @\$14,492
18	\$7,567,000 @\$16,558	\$6,658,960 @\$14,571
19	\$7,581,000 @\$16,589	\$6,671,280 @\$14,598
23	\$7,622,000 @\$16,678	\$6,707,360 @\$14,677
25	\$7,635,000 @\$16,707	\$6,718,800 @\$14,702
28	\$7,690,000 @\$16,827	\$6,767,200 @\$14,808
29	\$7,704,000 @\$16,858	\$6,779,520 @\$14,835
31	\$7,729,000 @\$16,912	\$6,801,520 @\$14,883
32	\$7,743,000 @\$16,943	\$6,813,840 @\$14,910
33	\$7,757,000 @\$16,974	\$6,826,160 @\$14,937
36	\$7,785,000 @\$17,035	\$6,850,800 @\$14,991
37	\$7,799,000 @\$17,066	\$6,863,120 @\$15,018
38	\$7,827,000 @\$17,127	\$6,887,760 @\$15,072
41	\$7,869,000 @\$17,219	\$6,924,720 @\$15,153
42	\$7,883,000 @\$17,249	\$6,937,040 @\$15,180
45	\$7,912,000 @\$17,313	\$6,962,560 @\$15,235
46	\$7,926,000 @\$17,344	\$6,974,880 @\$15,262

第1座(1B) D : 2房 435'		
樓層	訂價	折實價12%
9	\$6,925,000 @\$15,920	\$6,094,000 @\$14,009
12	\$6,967,000 @\$16,016	\$6,130,960 @\$14,094
15	\$6,981,000 @\$16,048	\$6,143,280 @\$14,122
16	\$7,002,000 @\$16,097	\$6,161,760 @\$14,165
18	\$7,040,000 @\$16,184	\$6,195,200 @\$14,242
19	\$7,053,000 @\$16,214	\$6,206,640 @\$14,268
23	\$7,091,000 @\$16,301	\$6,240,080 @\$14,345
25	\$7,104,000 @\$16,331	\$6,251,520 @\$14,371
28	\$7,155,000 @\$16,448	\$6,296,400 @\$14,474
29	\$7,168,000 @\$16,478	\$6,307,840 @\$14,501
31	\$7,191,000 @\$16,531	\$6,328,080 @\$14,547
32	\$7,204,000 @\$16,561	\$6,339,520 @\$14,574
33	\$7,217,000 @\$16,591	\$6,350,960 @\$14,600
35	\$7,230,000 @\$16,621	\$6,362,400 @\$14,626
36	\$7,243,000 @\$16,651	\$6,373,840 @\$14,653
37	\$7,256,000 @\$16,680	\$6,385,280 @\$14,679
38	\$7,283,000 @\$16,743	\$6,409,040 @\$14,733
41	\$7,322,000 @\$16,832	\$6,443,360 @\$14,812
42	\$7,335,000 @\$16,862	\$6,454,800 @\$14,839
45	\$7,362,000 @\$16,924	\$6,478,560 @\$14,893
46	\$7,375,000 @\$16,954	\$6,490,000 @\$14,920

第1座(1B) E : 1房 322'		
樓層	訂價	折實價12%
9	\$5,132,000 @\$15,938	\$4,516,160 @\$14,025
12	\$5,162,000 @\$16,031	\$4,542,560 @\$14,107
15	\$5,173,000 @\$16,065	\$4,552,240 @\$14,137
16	\$5,222,000 @\$16,217	\$4,595,360 @\$14,271
18	\$5,250,000 @\$16,304	\$4,620,000 @\$14,348
19	\$5,260,000 @\$16,335	\$4,628,800 @\$14,375
23	\$5,288,000 @\$16,422	\$4,653,440 @\$14,452
25	\$5,298,000 @\$16,453	\$4,662,240 @\$14,479
28	\$5,336,000 @\$16,571	\$4,695,680 @\$14,583
29	\$5,346,000 @\$16,602	\$4,704,480 @\$14,610
31	\$5,365,000 @\$16,661	\$4,721,200 @\$14,662
32	\$5,375,000 @\$16,693	\$4,730,000 @\$14,689
33	\$5,384,000 @\$16,720	\$4,737,920 @\$14,714
35	\$5,394,000 @\$16,752	\$4,746,720 @\$14,741
36	\$5,404,000 @\$16,783	\$4,755,520 @\$14,769
37	\$5,413,000 @\$16,811	\$4,763,440 @\$14,793
38	\$5,426,000 @\$16,851	\$4,774,880 @\$14,829
41	\$5,446,000 @\$16,913	\$4,792,480 @\$14,883
42	\$5,452,000 @\$16,932	\$4,797,760 @\$14,900
45	\$5,466,000 @\$16,975	\$4,810,080 @\$14,938
46	\$5,472,000 @\$16,994	\$4,815,360 @\$14,955

紅色為最高售價、最高平均呎價；藍色為最低售價、最低平均呎價