

T2 A: 3房 945'		
樓層	訂價	折實價6%
6	\$16,776,800 @\$17,753	\$15,770,192 @\$16,688
7	\$17,392,000 @\$18,404	\$16,348,480 @\$17,300
8	\$17,995,200 @\$19,043	\$16,915,488 @\$17,900
9	\$18,900,000 @\$20,000	\$17,766,000 @\$18,800
10	\$19,603,700 @\$20,745	\$18,427,478 @\$19,500
11	\$20,307,400 @\$21,489	\$19,088,956 @\$20,200
12	\$21,011,200 @\$22,234	\$19,750,528 @\$20,900
15	\$21,916,000 @\$23,192	\$20,601,040 @\$21,800
16	\$22,820,700 @\$24,149	\$21,451,458 @\$22,700

T2 D: 2房 724'		
樓層	訂價	折實價6%
6	\$13,555,700 @\$18,723	\$12,742,358 @\$17,600
7	\$13,632,800 @\$18,830	\$12,814,832 @\$17,700
8	\$13,825,300 @\$19,096	\$12,995,782 @\$17,950
9	\$14,480,000 @\$20,000	\$13,611,200 @\$18,800
10	\$15,096,200 @\$20,851	\$14,190,428 @\$19,600
11	\$15,635,300 @\$21,596	\$14,697,182 @\$20,300
12	\$16,097,400 @\$22,234	\$15,131,556 @\$20,900
15	\$16,790,600 @\$23,191	\$15,783,164 @\$21,800
16	\$17,483,800 @\$24,149	\$16,434,772 @\$22,700

T5 A: 3房 985'		
樓層	訂價	折實價6%
6	\$17,918,600 @\$18,191	\$16,843,484 @\$17,100
7	\$18,233,000 @\$18,511	\$17,139,020 @\$17,400
8	\$18,652,100 @\$18,936	\$17,532,974 @\$17,800
9	\$19,228,500 @\$19,521	\$18,074,790 @\$18,350
10	\$19,804,800 @\$20,106	\$18,616,512 @\$18,900
11	\$20,538,300 @\$20,851	\$19,306,002 @\$19,600
12	\$21,376,600 @\$21,702	\$20,094,004 @\$20,400

T5 B: 2房 726'/728'		
樓層	訂價	折實價6%
6	\$13,320,900 @\$18,298	\$12,521,646 @\$17,200
7	\$13,630,600 @\$18,723	\$12,812,764 @\$17,600
8	\$14,327,700 @\$19,681	\$13,468,038 @\$18,500
9	\$14,714,900 @\$20,213	\$13,832,006 @\$19,000
10	\$15,137,900 @\$20,851	\$14,229,626 @\$19,600
11	\$15,601,300 @\$21,489	\$14,665,222 @\$20,200
12	\$16,141,900 @\$22,234	\$15,173,386 @\$20,900

T5 F: 3房 768'		
樓層	訂價	折實價6%
11	\$14,624,700 @\$19,043	\$13,747,218 @\$17,900
12	\$15,237,400 @\$19,840	\$14,323,156 @\$18,650
15	\$15,850,200 @\$20,638	\$14,899,188 @\$19,400
16	\$16,258,700 @\$21,170	\$15,283,178 @\$19,900
17	\$16,748,900 @\$21,808	\$15,743,966 @\$20,500
18	\$17,320,900 @\$22,553	\$16,281,646 @\$21,200

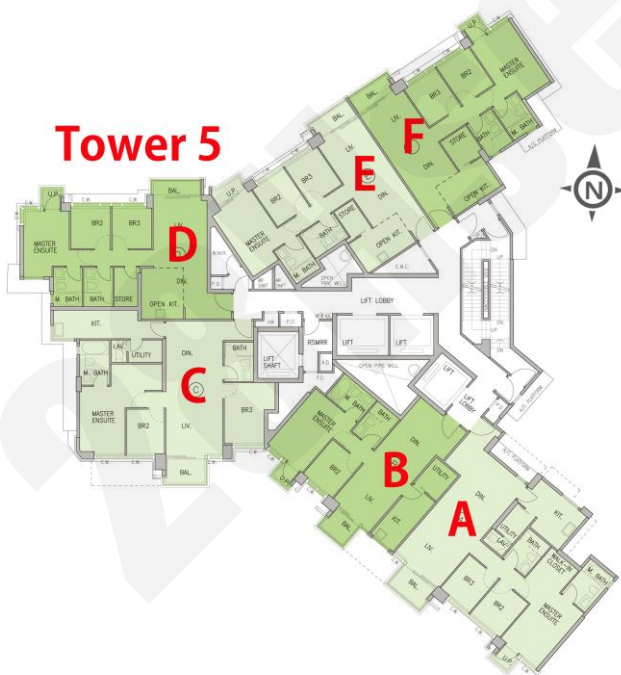
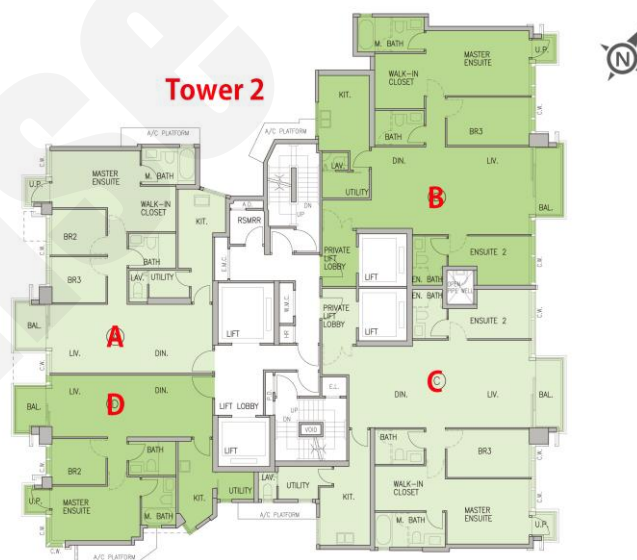

19	\$17,892,800 @\$23,298	\$16,819,232 @\$21,900
----	---------------------------	---------------------------

紅色為最高售價、最高平均呎價；藍色為最低售價、最低平均呎價



香港屋網

T6 C: 3房 768'		
樓層	訂價	折實價6%
10	\$13,797,900 @\$17,966	\$12,970,026 @\$16,888
11	\$14,052,800 @\$18,298	\$13,209,632 @\$17,200
12	\$14,257,000 @\$18,564	\$13,401,580 @\$17,450
15	\$14,461,300 @\$18,830	\$13,593,622 @\$17,700
16	\$14,665,500 @\$19,096	\$13,785,570 @\$17,950
17	\$14,869,800 @\$19,362	\$13,977,612 @\$18,200
18	\$15,237,400 @\$19,840	\$14,323,156 @\$18,650
19	\$15,441,700 @\$20,106	\$14,515,198 @\$18,900
20	\$15,646,000 @\$20,372	\$14,707,240 @\$19,150
21	\$15,891,100 @\$20,692	\$14,937,634 @\$19,450
22	\$16,136,200 @\$21,011	\$15,168,028 @\$19,750
23	\$16,381,300 @\$21,330	\$15,398,422 @\$20,050
25	\$16,626,400 @\$21,649	\$15,628,816 @\$20,350
26	\$16,871,500 @\$21,968	\$15,859,210 @\$20,650
T6 D: 2房 712'		
樓層	訂價	折實價6%
10	\$12,117,700 @\$17,019	\$11,390,638 @\$15,998
11	\$12,763,000 @\$17,926	\$11,997,220 @\$16,850
12	\$12,914,500 @\$18,138	\$12,139,630 @\$17,050
15	\$13,066,000 @\$18,351	\$12,282,040 @\$17,250
16	\$13,217,400 @\$18,564	\$12,424,356 @\$17,450
17	\$13,368,900 @\$18,777	\$12,566,766 @\$17,650
18	\$13,596,200 @\$19,096	\$12,780,428 @\$17,950
19	\$13,785,500 @\$19,362	\$12,958,370 @\$18,200
20	\$14,050,600 @\$19,734	\$13,207,564 @\$18,550
21	\$14,240,000 @\$20,000	\$13,385,600 @\$18,800
22	\$14,429,400 @\$20,266	\$13,563,636 @\$19,050
23	\$14,694,500 @\$20,638	\$13,812,830 @\$19,400
25	\$14,959,600 @\$21,011	\$14,062,024 @\$19,750
26	\$15,224,700 @\$21,383	\$14,311,218 @\$20,100

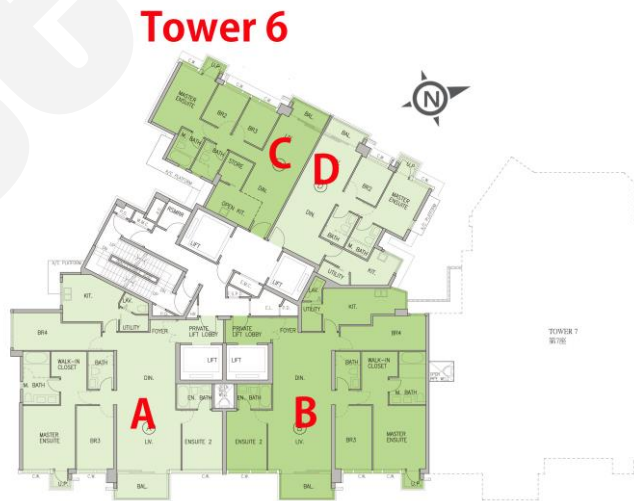

5座B8: 1房 354'		
樓層	訂價	折實價16%
16	\$7,967,000 @\$22,506	\$6,692,280 @\$18,905
15	\$7,927,000 @\$22,393	\$6,658,680 @\$18,810
12	\$7,887,000 @\$22,280	\$6,625,080 @\$18,715
11	\$7,846,000 @\$22,164	\$6,590,640 @\$18,618
10	\$7,807,000 @\$22,054	\$6,557,880 @\$18,525
9	\$7,768,000 @\$21,944	\$6,525,120 @\$18,433
8	\$7,768,000 @\$21,944	\$6,525,120 @\$18,433
7	\$7,689,000 @\$21,720	\$6,458,760 @\$18,245
6	\$7,651,000 @\$21,613	\$6,426,840 @\$18,155
5	\$7,596,000 @\$21,458	\$6,380,640 @\$18,024
3	\$7,543,000 @\$21,308	\$6,336,120 @\$17,899
2	\$7,490,000 @\$21,158	\$6,291,600 @\$17,773
1	\$7,437,000 @\$21,008	\$6,247,080 @\$17,647
5座B7: 2房 464'		
樓層	訂價	折實價16%
16	\$9,820,000 @\$21,164	\$8,248,800 @\$17,778
15	\$9,771,000 @\$21,058	\$8,207,640 @\$17,689
12	\$9,723,000 @\$20,955	\$8,167,320 @\$17,602
11	\$9,674,000 @\$20,849	\$8,126,160 @\$17,513
10	\$9,626,000 @\$20,746	\$8,085,840 @\$17,426
9	\$9,579,000 @\$20,644	\$8,046,360 @\$17,341
8	\$9,579,000 @\$20,644	\$8,046,360 @\$17,341
7	\$9,483,000 @\$20,438	\$7,965,720 @\$17,168
6	\$9,436,000 @\$20,336	\$7,926,240 @\$17,082
5	\$9,370,000 @\$20,194	\$7,870,800 @\$16,963
3	\$9,305,000 @\$20,054	\$7,816,200 @\$16,845
2	\$9,240,000 @\$19,914	\$7,761,600 @\$16,728
1	\$9,176,000 @\$19,776	\$7,707,840 @\$16,612
5座B6: 2房 464'		
樓層	訂價	折實價16%
16	\$9,800,000 @\$21,121	\$8,232,000 @\$17,741
15	\$9,751,000 @\$21,015	\$8,190,840 @\$17,653
12	\$9,702,000 @\$20,909	\$8,149,680 @\$17,564
11	\$9,655,000 @\$20,808	\$8,110,200 @\$17,479
10	\$9,607,000 @\$20,705	\$8,069,880 @\$17,392
9	\$9,558,000 @\$20,599	\$8,028,720 @\$17,303
8	\$9,558,000 @\$20,599	\$8,028,720 @\$17,303
7	\$9,464,000 @\$20,397	\$7,949,760 @\$17,133
6	\$9,417,000 @\$20,295	\$7,910,280 @\$17,048
5	\$9,351,000 @\$20,153	\$7,854,840 @\$16,929
3	\$9,287,000 @\$20,015	\$7,801,080 @\$16,813
2	\$9,223,000 @\$19,877	\$7,747,320 @\$16,697
1	\$9,158,000 @\$19,737	\$7,692,720 @\$16,579



5座B5: 1房及儲物室 384'		
樓層	訂價	折實價16%
16	\$8,556,000 @\$22,281	\$7,187,040 @\$18,716
15	\$8,514,000 @\$22,172	\$7,151,760 @\$18,624
12	\$8,471,000 @\$22,060	\$7,115,640 @\$18,530
11	\$8,430,000 @\$21,953	\$7,081,200 @\$18,441
10	\$8,387,000 @\$21,841	\$7,045,080 @\$18,347
9	\$8,345,000 @\$21,732	\$7,009,800 @\$18,255
8	\$8,345,000 @\$21,732	\$7,009,800 @\$18,255
7	\$8,263,000 @\$21,518	\$6,940,920 @\$18,075
6	\$8,221,000 @\$21,409	\$6,905,640 @\$17,983
5	\$8,164,000 @\$21,260	\$6,857,760 @\$17,859
3	\$8,108,000 @\$21,115	\$6,810,720 @\$17,736
2	\$8,051,000 @\$20,966	\$6,762,840 @\$17,612
1	\$7,995,000 @\$20,820	\$6,715,800 @\$17,489
5座A5: 3房連套房及工人套房 762'		
樓層	訂價	折實價16%
15	\$16,660,000 @\$21,864	\$13,994,400 @\$18,365
12	\$16,593,000 @\$21,776	\$13,938,120 @\$18,291
11	\$16,526,000 @\$21,688	\$13,881,840 @\$18,218
10	\$16,461,000 @\$21,602	\$13,827,240 @\$18,146
9	\$16,395,000 @\$21,516	\$13,771,800 @\$18,073
8	\$16,395,000 @\$21,516	\$13,771,800 @\$18,073
7	\$16,264,000 @\$21,344	\$13,661,760 @\$17,929
6	\$16,199,000 @\$21,259	\$13,607,160 @\$17,857
5	\$16,167,000 @\$21,217	\$13,580,280 @\$17,822
5	\$8,164,000 @\$21,260	\$6,857,760 @\$17,859

5座B3: 1房及儲物室 382'		
樓層	訂價	折實價16%
16	\$8,492,000 @\$22,230	\$7,133,280 @\$18,674
15	\$8,449,000 @\$22,118	\$7,097,160 @\$18,579
12	\$8,407,000 @\$22,008	\$7,061,880 @\$18,487
11	\$8,365,000 @\$21,898	\$7,026,600 @\$18,394
10	\$8,324,000 @\$21,791	\$6,992,160 @\$18,304
9	\$8,282,000 @\$21,681	\$6,956,880 @\$18,212
8	\$8,282,000 @\$21,681	\$6,956,880 @\$18,212
7	\$8,200,000 @\$21,466	\$6,888,000 @\$18,031
6	\$8,160,000 @\$21,361	\$6,854,400 @\$17,943
5	\$8,102,000 @\$21,209	\$6,805,680 @\$17,816
3	\$8,046,000 @\$21,063	\$6,758,640 @\$17,693
2	\$7,990,000 @\$20,916	\$6,711,600 @\$17,570
1	\$7,935,000 @\$20,772	\$6,665,400 @\$17,449

樓層
16
15
12
11
10
9
8
7
6
5
3
2
1

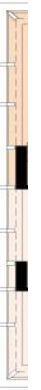

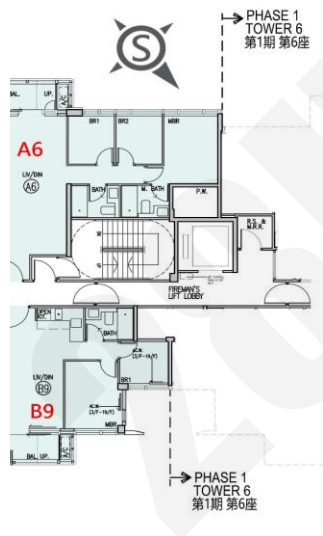

B2 : 2房及儲物室 547'/557'

訂價	折實價16%
\$11,399,000 @\$20,839	\$9,575,160 @\$17,505
\$11,370,000 @\$20,786	\$9,550,800 @\$17,460
\$11,343,000 @\$20,737	\$9,528,120 @\$17,419
\$11,314,000 @\$20,684	\$9,503,760 @\$17,374
\$11,287,000 @\$20,634	\$9,481,080 @\$17,333
\$11,260,000 @\$20,585	\$9,458,400 @\$17,291
\$11,260,000 @\$20,585	\$9,458,400 @\$17,291
\$11,204,000 @\$20,483	\$9,411,360 @\$17,205
\$11,176,000 @\$20,431	\$9,387,840 @\$17,162
\$11,132,000 @\$20,351	\$9,350,880 @\$17,095
\$11,088,000 @\$20,271	\$9,313,920 @\$17,027
\$11,044,000 @\$20,190	\$9,276,960 @\$16,960
\$11,200,000 @\$20,108	\$9,408,000 @\$16,890

