

C : 2房 453'		
樓層	訂價	折實價15%
3	\$6,039,000 @\$13,331	\$5,133,150 @\$11,331
5	\$6,051,000 @\$13,358	\$5,143,350 @\$11,354
6	\$6,064,000 @\$13,386	\$5,154,400 @\$11,378
7	\$6,075,000 @\$13,411	\$5,163,750 @\$11,399
8	\$6,100,000 @\$13,466	\$5,185,000 @\$11,446
9	\$6,100,000 @\$13,466	\$5,185,000 @\$11,446
10	\$6,112,000 @\$13,492	\$5,195,200 @\$11,468
11	\$6,125,000 @\$13,521	\$5,206,250 @\$11,493
12	\$6,136,000 @\$13,545	\$5,215,600 @\$11,513
15	\$6,148,000 @\$13,572	\$5,225,800 @\$11,536
16	\$6,161,000 @\$13,600	\$5,236,850 @\$11,560
17	\$6,173,000 @\$13,627	\$5,247,050 @\$11,583
19	\$6,198,000 @\$13,682	\$5,268,300 @\$11,630
20	\$6,211,000 @\$13,711	\$5,279,350 @\$11,654
21	\$6,227,000 @\$13,746	\$5,292,950 @\$11,684
22	\$6,244,000 @\$13,784	\$5,307,400 @\$11,716
23	\$6,259,000 @\$13,817	\$5,320,150 @\$11,744
25	\$6,275,000 @\$13,852	\$5,333,750 @\$11,774
26	\$6,292,000 @\$13,890	\$5,348,200 @\$11,806
27	\$6,308,000 @\$13,925	\$5,361,800 @\$11,836

RISKARS TOWER 2B
RISKARS 第28座



E : 2房 442'		
樓層	訂價	折實價15%
3	\$5,936,000 @\$13,430	\$5,045,600 @\$11,415
5	\$5,948,000 @\$13,457	\$5,055,800 @\$11,438
6	\$5,960,000 @\$13,484	\$5,066,000 @\$11,462
7	\$5,972,000 @\$13,511	\$5,076,200 @\$11,485
8	\$5,996,000 @\$13,566	\$5,096,600 @\$11,531
9	\$5,996,000 @\$13,566	\$5,096,600 @\$11,531
10	\$6,008,000 @\$13,593	\$5,106,800 @\$11,554
11	\$6,020,000 @\$13,620	\$5,117,000 @\$11,577
12	\$6,033,000 @\$13,649	\$5,128,050 @\$11,602
15	\$6,045,000 @\$13,676	\$5,138,250 @\$11,625
16	\$6,056,000 @\$13,701	\$5,147,600 @\$11,646
17	\$6,068,000 @\$13,729	\$5,157,800 @\$11,669
18	\$6,093,000 @\$13,785	\$5,179,050 @\$11,717
19	\$6,093,000 @\$13,785	\$5,179,050 @\$11,717
20	\$6,106,000 @\$13,814	\$5,190,100 @\$11,742
21	\$6,121,000 @\$13,848	\$5,202,850 @\$11,771
22	\$6,138,000 @\$13,887	\$5,217,300 @\$11,804
23	\$6,153,000 @\$13,921	\$5,230,050 @\$11,833
25	\$6,169,000 @\$13,957	\$5,243,650 @\$11,863
26	\$6,185,000 @\$13,993	\$5,257,250 @\$11,894
27	\$6,201,000 @\$14,029	\$5,270,850 @\$11,925

F : 2房 443'		
樓層	訂價	折實價15%
3	\$5,941,000 @\$13,411	\$5,049,850 @\$11,399
5	\$5,953,000 @\$13,438	\$5,060,050 @\$11,422
6	\$5,965,000 @\$13,465	\$5,070,250 @\$11,445
7	\$5,978,000 @\$13,494	\$5,081,300 @\$11,470
8	\$6,001,000 @\$13,546	\$5,100,850 @\$11,514
9	\$6,001,000 @\$13,546	\$5,100,850 @\$11,514
10	\$6,013,000 @\$13,573	\$5,111,050 @\$11,537
11	\$6,025,000 @\$13,600	\$5,121,250 @\$11,560
12	\$6,038,000 @\$13,630	\$5,132,300 @\$11,585
15	\$6,049,000 @\$13,655	\$5,141,650 @\$11,606
16	\$6,061,000 @\$13,682	\$5,151,850 @\$11,629
17	\$6,074,000 @\$13,711	\$5,162,900 @\$11,654
18	\$6,098,000 @\$13,765	\$5,183,300 @\$11,700
19	\$6,098,000 @\$13,765	\$5,183,300 @\$11,700
20	\$6,111,000 @\$13,795	\$5,194,350 @\$11,725
21	\$6,126,000 @\$13,828	\$5,207,100 @\$11,754
22	\$6,142,000 @\$13,865	\$5,220,700 @\$11,785
23	\$6,158,000 @\$13,901	\$5,234,300 @\$11,816
25	\$6,174,000 @\$13,937	\$5,247,900 @\$11,846
26	\$6,191,000 @\$13,975	\$5,262,350 @\$11,879
27	\$6,206,000 @\$14,009	\$5,275,100 @\$11,908

紅色為最高售價、最高平均呎價；藍色為最低售價、最低平均呎價

E: 開放式 252'		
樓層	訂價	折實價15%
3	\$3,515,000 @\$13,948	\$2,987,750 @\$11,856
5	\$3,522,000 @\$13,976	\$2,993,700 @\$11,880
6	\$3,529,000 @\$14,004	\$2,999,650 @\$11,903
7	\$3,536,000 @\$14,032	\$3,005,600 @\$11,927
8	\$3,551,000 @\$14,091	\$3,018,350 @\$11,978
9	\$3,551,000 @\$14,091	\$3,018,350 @\$11,978
10	\$3,558,000 @\$14,119	\$3,024,300 @\$12,001
11	\$3,566,000 @\$14,151	\$3,031,100 @\$12,028
12	\$3,573,000 @\$14,179	\$3,037,050 @\$12,052
15	\$3,580,000 @\$14,206	\$3,043,000 @\$12,075

F: 1房 303'		
樓層	訂價	折實價15%
3	\$4,302,000 @\$14,198	\$3,656,700 @\$12,068
5	\$4,311,000 @\$14,228	\$3,664,350 @\$12,094
6	\$4,320,000 @\$14,257	\$3,672,000 @\$12,119
7	\$4,328,000 @\$14,284	\$3,678,800 @\$12,141
8	\$4,346,000 @\$14,343	\$3,694,100 @\$12,192
9	\$4,346,000 @\$14,343	\$3,694,100 @\$12,192
10	\$4,354,000 @\$14,370	\$3,700,900 @\$12,214
11	\$4,364,000 @\$14,403	\$3,709,400 @\$12,242
12	\$4,372,000 @\$14,429	\$3,716,200 @\$12,265
15	\$4,381,000 @\$14,459	\$3,723,850 @\$12,290

H: 3房 543'		
樓層	訂價	折實價15%
3	\$7,159,000 @\$13,184	\$6,085,150 @\$11,207
5	\$7,174,000 @\$13,212	\$6,097,900 @\$11,230
6	\$7,188,000 @\$13,238	\$6,109,800 @\$11,252
7	\$7,202,000 @\$13,263	\$6,121,700 @\$11,274
8	\$7,232,000 @\$13,319	\$6,147,200 @\$11,321
9	\$7,232,000 @\$13,319	\$6,147,200 @\$11,321
10	\$7,246,000 @\$13,344	\$6,159,100 @\$11,343
11	\$7,261,000 @\$13,372	\$6,171,850 @\$11,366
12	\$7,274,000 @\$13,396	\$6,182,900 @\$11,387
15	\$7,289,000 @\$13,424	\$6,195,650 @\$11,410
16	\$7,304,000 @\$13,451	\$6,208,400 @\$11,434
17	\$7,319,000 @\$13,479	\$6,221,150 @\$11,457
18	\$7,348,000 @\$13,532	\$6,245,800 @\$11,502
19	\$7,348,000 @\$13,532	\$6,245,800 @\$11,502
20	\$7,362,000 @\$13,558	\$6,257,700 @\$11,524
21	\$7,382,000 @\$13,595	\$6,274,700 @\$11,556
22	\$7,401,000 @\$13,630	\$6,290,850 @\$11,585
23	\$7,420,000 @\$13,665	\$6,307,000 @\$11,615
25	\$7,440,000 @\$13,702	\$6,324,000 @\$11,646
26	\$7,459,000 @\$13,737	\$6,340,150 @\$11,676

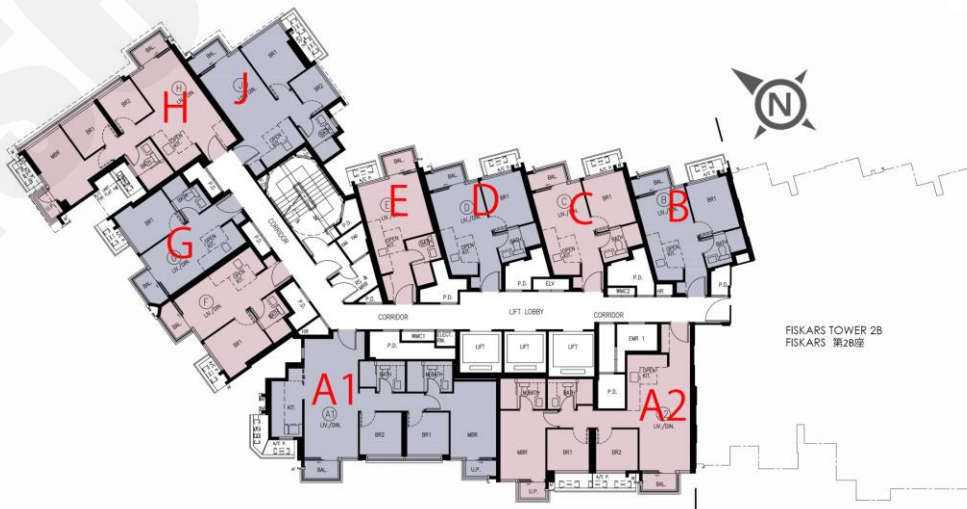

紅色為最高售價、最高平均呎價；藍色為最低售價、最低平均呎價

D : 2房 439'		
樓層	訂價	折實價15%
3	\$5,722,000 @\$13,034	\$4,863,700 @\$11,079
5	\$5,734,000 @\$13,062	\$4,873,900 @\$11,102
6	\$5,746,000 @\$13,089	\$4,884,100 @\$11,126
7	\$5,756,000 @\$13,112	\$4,892,600 @\$11,145
8	\$5,780,000 @\$13,166	\$4,913,000 @\$11,191
9	\$5,780,000 @\$13,166	\$4,913,000 @\$11,191
10	\$5,792,000 @\$13,194	\$4,923,200 @\$11,215
11	\$5,804,000 @\$13,221	\$4,933,400 @\$11,238
12	\$5,815,000 @\$13,246	\$4,942,750 @\$11,259
15	\$5,827,000 @\$13,273	\$4,952,950 @\$11,282
16	\$5,839,000 @\$13,301	\$4,963,150 @\$11,306
17	\$5,851,000 @\$13,328	\$4,973,350 @\$11,329
18	\$5,873,000 @\$13,378	\$4,992,050 @\$11,371
19	\$5,873,000 @\$13,378	\$4,992,050 @\$11,371
20	\$5,885,000 @\$13,405	\$5,002,250 @\$11,395
21	\$5,900,000 @\$13,440	\$5,015,000 @\$11,424
22	\$5,916,000 @\$13,476	\$5,028,600 @\$11,455
23	\$5,932,000 @\$13,513	\$5,042,200 @\$11,486
25	\$5,947,000 @\$13,547	\$5,054,950 @\$11,515
26	\$5,962,000 @\$13,581	\$5,067,700 @\$11,544
27	\$5,978,000 @\$13,617	\$5,081,300 @\$11,575
28	\$6,008,000 @\$13,686	\$5,106,800 @\$11,633
29	\$6,008,000 @\$13,686	\$5,106,800 @\$11,633
30	\$6,025,000 @\$13,724	\$5,121,250 @\$11,666
31	\$6,040,000 @\$13,759	\$5,134,000 @\$11,695
32	\$6,055,000 @\$13,793	\$5,146,750 @\$11,724
33	\$6,072,000 @\$13,831	\$5,161,200 @\$11,757



F : 2房 416'		
樓層	訂價	折實價15%
3	\$5,655,000 @\$13,594	\$4,806,750 @\$11,555
5	\$5,667,000 @\$13,623	\$4,816,950 @\$11,579
6	\$5,679,000 @\$13,651	\$4,827,150 @\$11,604
7	\$5,689,000 @\$13,675	\$4,835,650 @\$11,624
8	\$5,713,000 @\$13,733	\$4,856,050 @\$11,673
9	\$5,713,000 @\$13,733	\$4,856,050 @\$11,673
10	\$5,725,000 @\$13,762	\$4,866,250 @\$11,698
11	\$5,735,000 @\$13,786	\$4,874,750 @\$11,718
12	\$5,747,000 @\$13,815	\$4,884,950 @\$11,743
15	\$5,759,000 @\$13,844	\$4,895,150 @\$11,767
16	\$5,771,000 @\$13,873	\$4,905,350 @\$11,792
17	\$5,781,000 @\$13,897	\$4,913,850 @\$11,812

G : 2房 418'		
樓層	訂價	折實價15%
3	\$5,667,000 @\$13,557	\$4,816,950 @\$11,524
5	\$5,678,000 @\$13,584	\$4,826,300 @\$11,546
6	\$5,689,000 @\$13,610	\$4,835,650 @\$11,569
7	\$5,701,000 @\$13,639	\$4,845,850 @\$11,593
8	\$5,724,000 @\$13,694	\$4,865,400 @\$11,640
9	\$5,724,000 @\$13,694	\$4,865,400 @\$11,640
10	\$5,735,000 @\$13,720	\$4,874,750 @\$11,662
11	\$5,747,000 @\$13,749	\$4,884,950 @\$11,686
12	\$5,759,000 @\$13,778	\$4,895,150 @\$11,711
15	\$5,769,000 @\$13,801	\$4,903,650 @\$11,731
16	\$5,781,000 @\$13,830	\$4,913,850 @\$11,756
17	\$5,793,000 @\$13,859	\$4,924,050 @\$11,780
18	\$5,816,000 @\$13,914	\$4,943,600 @\$11,827

紅色為最高售價、最高平均呎價；藍色為最低售價、最低平均呎價