

18/F - 23/F, 25/F - 29/F FLOOR PLAN
18樓至23樓、25樓至29樓平面圖

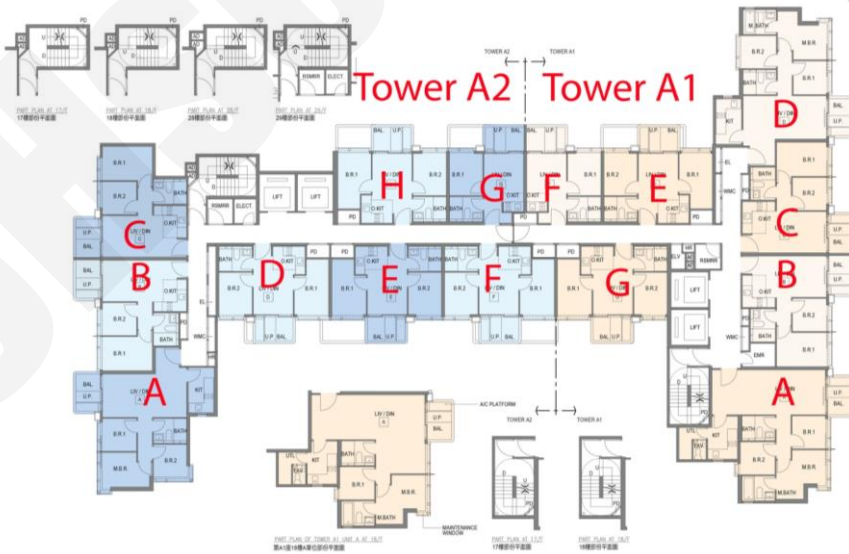

TA1 C: 2房 414'

樓層	訂價	折實價15%
12	\$9,922,000 @\$23,966	\$8,433,700 @\$20,371
15	\$9,992,000 @\$24,135	\$8,493,200 @\$20,515
16	\$10,032,000 @\$24,232	\$8,527,200 @\$20,597
17	\$10,071,000 @\$24,326	\$8,560,350 @\$20,677

TA1 F: 1房 269'/272'

樓層	訂價	折實價15%
12	\$5,638,000 @\$20,959	\$4,792,300 @\$17,815
15	\$5,689,000 @\$21,149	\$4,835,650 @\$17,976
16	\$5,711,000 @\$21,230	\$4,854,350 @\$18,046
17	\$5,743,000 @\$21,349	\$4,881,550 @\$18,147
18	\$6,123,000 @\$22,511	\$5,204,550 @\$19,134
19	\$6,123,000 @\$22,511	\$5,204,550 @\$19,134
20	\$6,152,000 @\$22,618	\$5,229,200 @\$19,225
21	\$6,184,000 @\$22,735	\$5,256,400 @\$19,325

TA1 J: 1房 278'

樓層	訂價	折實價15%
15	\$5,980,000 @\$21,511	\$5,083,000 @\$18,284
16	\$6,004,000 @\$21,597	\$5,103,400 @\$18,358
17	\$6,030,000 @\$21,691	\$5,125,500 @\$18,437

TA1 E: 2房 378'

樓層	訂價	折實價15%
18	\$8,298,000 @\$21,952	\$7,053,300 @\$18,660
19	\$8,298,000 @\$21,952	\$7,053,300 @\$18,660
20	\$8,338,000 @\$22,058	\$7,087,300 @\$18,749
21	\$8,380,000 @\$22,169	\$7,123,000 @\$18,844

TA2 H: 2房 272'/382'

樓層	訂價	折實價15%
12	\$5,718,000 @\$21,022	\$4,860,300 @\$17,869
15	\$5,763,000 @\$21,188	\$4,898,550 @\$18,009
16	\$5,791,000 @\$21,290	\$4,922,350 @\$18,097
17	\$5,820,000 @\$21,397	\$4,947,000 @\$18,188
18	\$8,641,000 @\$22,620	\$7,344,850 @\$19,227
19	\$8,641,000 @\$22,620	\$7,344,850 @\$19,227
20	\$8,683,000 @\$22,730	\$7,380,550 @\$19,321
21	\$8,727,000 @\$22,846	\$7,417,950 @\$19,419

TA2 A: 3房 545'

樓層	訂價	折實價15%
15	\$13,523,000 @\$24,813	\$11,494,550 @\$21,091
16	\$13,578,000 @\$24,914	\$11,541,300 @\$21,177
17	\$13,631,000 @\$25,011	\$11,586,350 @\$21,269

TA2 B: 2房 415'/418'

樓層	訂價	折實價15%
15	\$9,630,000 @\$23,038	\$8,185,500 @\$19,583
16	\$9,668,000 @\$23,129	\$8,217,800 @\$19,660
17	\$9,709,000 @\$23,227	\$8,252,650 @\$19,743
18	\$9,889,000 @\$23,829	\$8,405,650 @\$20,255
19	\$9,889,000 @\$23,829	\$8,405,650 @\$20,255
20	\$9,950,000 @\$23,976	\$8,457,500 @\$20,380
21	\$10,007,000 @\$24,113	\$8,505,950 @\$20,496

TA2 C: 2房 423'

樓層	訂價	折實價15%
15	\$9,747,000 @\$23,043	\$8,284,950 @\$19,586
16	\$9,785,000 @\$23,132	\$8,317,250 @\$19,663
17	\$9,823,000 @\$23,222	\$8,349,550 @\$19,739

TA2 D: 2房 277'/382'

樓層	訂價	折實價15%
15	\$5,960,000 @\$21,516	\$5,066,000 @\$18,289
16	\$5,983,000 @\$21,599	\$5,085,550 @\$18,359
17	\$6,008,000 @\$21,690	\$5,106,800 @\$18,436
18	\$8,500,000 @\$22,251	\$7,225,000 @\$18,914
19	\$8,500,000 @\$22,251	\$7,225,000 @\$18,914

TA2 G: 1房 270'

樓層	訂價	折實價15%
15	\$5,897,000 @\$21,841	\$5,012,450 @\$18,565
16	\$5,922,000 @\$21,933	\$5,033,700 @\$18,643
17	\$5,944,000 @\$22,015	\$5,052,400 @\$18,713

TA2 F: 2房 377'

樓層	訂價	折實價15%
18	\$8,516,000 @\$22,589	\$7,238,600 @\$19,201
19	\$8,516,000 @\$22,589	\$7,238,600 @\$19,201
20	\$8,567,000 @\$22,724	\$7,281,950 @\$19,316
21	\$8,617,000 @\$22,857	\$7,324,450 @\$19,428

紅色為最高售價、最高平均呎價；藍色為最低售價、最低平均呎價
以上的物業資料只供參考，一切以發展商最新公布為準，如有任何資料錯漏本網頁不會承擔任何責任。