

Tower 6

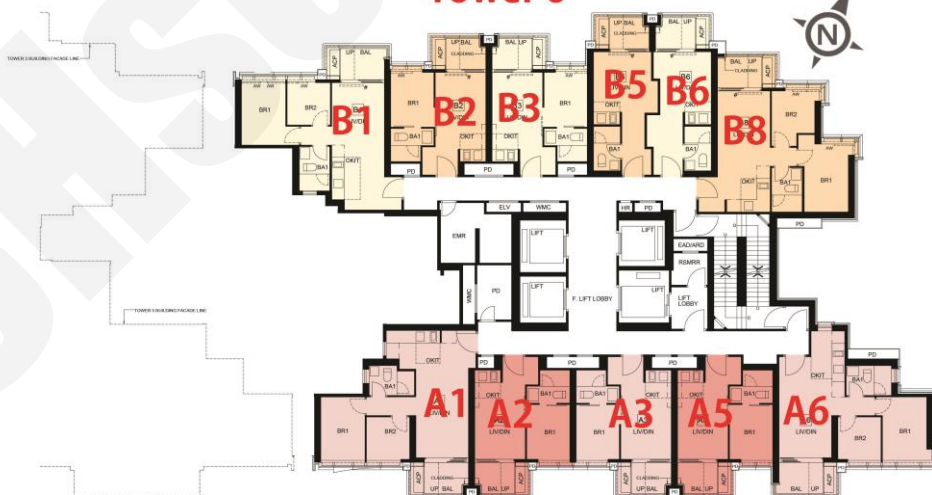

B1 : 2房 467'		
樓層	訂價	折實價13.5%
5	\$9,528,600 @ \$20,404	\$8,242,239 @ \$17,649
6	\$9,823,300 @ \$21,035	\$8,497,155 @ \$18,195
7	\$9,963,400 @ \$21,335	\$8,618,341 @ \$18,455
8	\$10,056,800 @ \$21,535	\$8,699,132 @ \$18,628
9	\$10,133,800 @ \$21,700	\$8,765,737 @ \$18,770
10	\$10,164,300 @ \$21,765	\$8,792,120 @ \$18,827
11	\$10,194,800 @ \$21,830	\$8,818,502 @ \$18,883
12	\$10,225,500 @ \$21,896	\$8,845,058 @ \$18,940
15	\$10,246,000 @ \$21,940	\$8,862,790 @ \$18,978
16	\$10,266,500 @ \$21,984	\$8,880,523 @ \$19,016
17	\$10,287,100 @ \$22,028	\$8,898,342 @ \$19,054
18	\$10,307,700 @ \$22,072	\$8,916,161 @ \$19,092
19	\$10,328,300 @ \$22,116	\$8,933,980 @ \$19,131
20	\$10,349,000 @ \$22,161	\$8,951,885 @ \$19,169
21	\$10,380,000 @ \$22,227	\$8,978,700 @ \$19,226
22	\$10,411,200 @ \$22,294	\$9,005,688 @ \$19,284
23	\$10,442,400 @ \$22,361	\$9,032,676 @ \$19,342
25	\$10,473,700 @ \$22,428	\$9,059,751 @ \$19,400
26	\$10,515,600 @ \$22,517	\$9,095,994 @ \$19,478
27	\$10,557,700 @ \$22,607	\$9,132,411 @ \$19,555
28	\$10,599,900 @ \$22,698	\$9,168,914 @ \$19,634
29	\$10,642,300 @ \$22,789	\$9,205,590 @ \$19,712
30	\$10,706,200 @ \$22,925	\$9,260,863 @ \$19,831

B2 : 1房 296'		
樓層	訂價	折實價13.5%
5	\$6,532,300 @ \$22,069	\$5,650,440 @ \$19,089
6	\$6,734,300 @ \$22,751	\$5,825,170 @ \$19,680
7	\$6,827,700 @ \$23,067	\$5,905,961 @ \$19,953
8	\$6,889,900 @ \$23,277	\$5,959,764 @ \$20,134
9	\$6,941,600 @ \$23,451	\$6,004,484 @ \$20,285
10	\$6,962,500 @ \$23,522	\$6,022,563 @ \$20,346
11	\$6,983,400 @ \$23,593	\$6,040,641 @ \$20,408
12	\$7,004,500 @ \$23,664	\$6,058,893 @ \$20,469
15	\$7,018,500 @ \$23,711	\$6,071,003 @ \$20,510
16	\$7,032,600 @ \$23,759	\$6,083,199 @ \$20,551
17	\$7,046,700 @ \$23,806	\$6,095,396 @ \$20,593
18	\$7,060,700 @ \$23,854	\$6,107,506 @ \$20,633

B3 : 1房 296'		
樓層	訂價	折實價13.5%
5	\$6,532,200 @ \$22,068	\$5,650,353 @ \$19,089
6	\$6,734,300 @ \$22,751	\$5,825,170 @ \$19,680
7	\$6,827,600 @ \$23,066	\$5,905,874 @ \$19,952
8	\$6,889,800 @ \$23,276	\$5,959,677 @ \$20,134
9	\$6,941,600 @ \$23,451	\$6,004,484 @ \$20,285
10	\$6,962,500 @ \$23,522	\$6,022,563 @ \$20,346
11	\$6,983,400 @ \$23,593	\$6,040,641 @ \$20,408
12	\$7,004,500 @ \$23,664	\$6,058,893 @ \$20,469
15	\$7,018,500 @ \$23,711	\$6,071,003 @ \$20,510
16	\$7,032,600 @ \$23,759	\$6,083,199 @ \$20,551
17	\$7,046,700 @ \$23,806	\$6,095,396 @ \$20,593
18	\$7,060,700 @ \$23,854	\$6,107,506 @ \$20,633

B8 : 2房 477'		
樓層	訂價	折實價13.5%
5	\$9,732,700 @ \$20,404	\$8,418,786 @ \$17,649
6	\$10,033,700 @ \$21,035	\$8,679,151 @ \$18,195
7	\$10,176,800 @ \$21,335	\$8,802,932 @ \$18,455
8	\$10,272,100 @ \$21,535	\$8,885,367 @ \$18,628
9	\$10,350,800 @ \$21,700	\$8,953,442 @ \$18,770
10	\$10,381,900 @ \$21,765	\$8,980,344 @ \$18,827
11	\$10,413,200 @ \$21,831	\$9,007,418 @ \$18,883
12	\$10,444,500 @ \$21,896	\$9,034,493 @ \$18,940
15	\$10,465,400 @ \$21,940	\$9,052,571 @ \$18,978
16	\$10,486,400 @ \$21,984	\$9,070,736 @ \$19,016
17	\$10,507,400 @ \$22,028	\$9,088,901 @ \$19,054
18	\$10,528,400 @ \$22,072	\$9,107,066 @ \$19,092
19	\$10,549,500 @ \$22,116	\$9,125,318 @ \$19,131
20	\$10,570,600 @ \$22,161	\$9,143,569 @ \$19,169
21	\$10,602,300 @ \$22,227	\$9,170,990 @ \$19,226
22	\$10,634,100 @ \$22,294	\$9,198,497 @ \$19,284
23	\$10,666,000 @ \$22,361	\$9,226,090 @ \$19,342
25	\$10,698,000 @ \$22,428	\$9,253,770 @ \$19,400
26	\$10,740,800 @ \$22,517	\$9,290,792 @ \$19,478
27	\$10,783,700 @ \$22,607	\$9,327,901 @ \$19,555
28	\$10,826,900 @ \$22,698	\$9,365,269 @ \$19,634
29	\$10,870,200 @ \$22,789	\$9,402,723 @ \$19,712
30	\$10,935,400 @ \$22,925	\$9,459,121 @ \$19,830

以上的物業資料只供參考。一切以發展商最新公布為準。如有任何資料錯誤本網頁不會承擔任何責任。
紅色為最高售價、最高平均呎價；藍色為最低售價、最低平均呎價

Tower 5

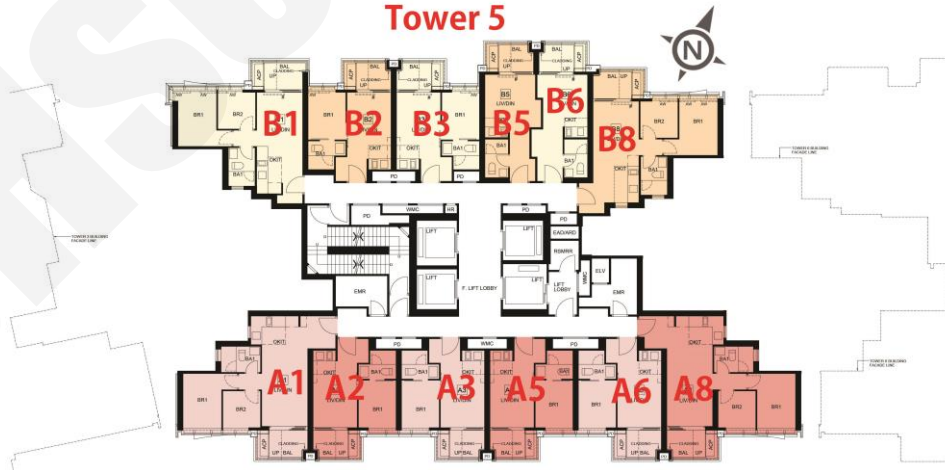

A5 : 1房 299'		
樓層	訂價	折實價13.5%
5	\$6,409,400 @\$21,436	\$5,544,131 @\$18,542
6	\$7,283,400 @\$24,359	\$6,300,141 @\$21,071
29	\$8,228,200 @\$27,519	\$7,117,393 @\$23,804
30	\$8,310,500 @\$27,794	\$7,188,583 @\$24,042

A8 : 2房 509'		
樓層	訂價	折實價13.5%
5	\$10,012,100 @\$19,670	\$8,660,467 @\$17,015
6	\$11,205,400 @\$22,015	\$9,692,671 @\$19,043
29	\$12,579,600 @\$24,714	\$10,881,354 @\$21,378
30	\$12,801,000 @\$25,149	\$11,072,865 @\$21,754

B1 : 2房 454'

樓層	訂價	折實價13.5%
5	\$9,309,000 @\$20,504	\$8,052,285 @\$17,736
6	\$9,646,600 @\$21,248	\$8,344,309 @\$18,380
7	\$9,784,200 @\$21,551	\$8,463,333 @\$18,642
8	\$9,875,800 @\$21,753	\$8,542,567 @\$18,816
9	\$9,951,500 @\$21,920	\$8,608,048 @\$18,960
10	\$9,981,400 @\$21,985	\$8,633,911 @\$19,017
11	\$10,011,500 @\$22,052	\$8,659,948 @\$19,075
12	\$10,041,600 @\$22,118	\$8,685,984 @\$19,132
15	\$10,061,700 @\$22,162	\$8,703,371 @\$19,170
16	\$10,081,900 @\$22,207	\$8,720,844 @\$19,209
17	\$10,102,100 @\$22,251	\$8,738,317 @\$19,247
18	\$10,122,300 @\$22,296	\$8,755,790 @\$19,286
19	\$10,142,500 @\$22,340	\$8,773,263 @\$19,324
20	\$10,162,800 @\$22,385	\$8,790,822 @\$19,363
21	\$10,193,300 @\$22,452	\$8,817,205 @\$19,421
22	\$10,223,900 @\$22,520	\$8,843,674 @\$19,479
23	\$10,254,500 @\$22,587	\$8,870,143 @\$19,538
25	\$10,285,300 @\$22,655	\$8,896,785 @\$19,596
26	\$10,326,500 @\$22,746	\$8,932,423 @\$19,675
27	\$10,367,800 @\$22,837	\$8,968,147 @\$19,754
28	\$10,409,200 @\$22,928	\$9,003,958 @\$19,833
29	\$10,450,900 @\$23,020	\$9,040,029 @\$19,912
30	\$10,513,600 @\$23,158	\$9,094,264 @\$20,031

B2 : 1房 299'		
樓層	訂價	折實價13.5%
5	\$6,568,600 @\$21,969	\$5,681,839 @\$19,003
6	\$6,807,000 @\$22,766	\$5,888,055 @\$19,692
7	\$6,896,900 @\$23,067	\$5,965,819 @\$19,953
8	\$6,959,700 @\$23,277	\$6,020,141 @\$20,134
9	\$7,012,000 @\$23,452	\$6,065,380 @\$20,286
10	\$7,033,100 @\$23,522	\$6,083,632 @\$20,347
11	\$7,054,200 @\$23,593	\$6,101,883 @\$20,408
12	\$7,075,500 @\$23,664	\$6,120,308 @\$20,469
15	\$7,089,600 @\$23,711	\$6,132,504 @\$20,510
16	\$7,103,800 @\$23,759	\$6,144,787 @\$20,551
17	\$7,118,100 @\$23,806	\$6,157,157 @\$20,592
18	\$7,132,300 @\$23,854	\$6,169,440 @\$20,634
19	\$7,146,600 @\$23,902	\$6,181,809 @\$20,675
20	\$7,160,900 @\$23,949	\$6,194,179 @\$20,716
21	\$7,182,300 @\$24,021	\$6,212,690 @\$20,778
22	\$7,203,900 @\$24,093	\$6,231,374 @\$20,841
23	\$7,225,500 @\$24,166	\$6,250,058 @\$20,903
25	\$7,247,200 @\$24,238	\$6,268,828 @\$20,966
26	\$7,276,200 @\$24,335	\$6,293,913 @\$21,050
27	\$7,290,700 @\$24,384	\$6,306,456 @\$21,092
28	\$7,305,300 @\$24,432	\$6,319,085 @\$21,134
29	\$7,319,900 @\$24,481	\$6,331,714 @\$21,176
30	\$7,349,200 @\$24,579	\$6,357,058 @\$21,261

B3 : 1房 296'		
樓層	訂價	折實價13.5%
5	\$6,498,600 @\$21,955	\$5,621,289 @\$18,991
6	\$6,734,300 @\$22,751	\$5,825,170 @\$19,680
7	\$6,827,600 @\$23,066	\$5,905,874 @\$19,952
8	\$6,889,800 @\$23,276	\$5,959,677 @\$20,134
9	\$6,941,600 @\$23,451	\$6,004,484 @\$20,285
10	\$6,962,500 @\$23,522	\$6,022,563 @\$20,346
11	\$6,983,400 @\$23,593	\$6,040,641 @\$20,408
12	\$7,004,500 @\$23,664	\$6,058,893 @\$20,469
15	\$7,018,500 @\$23,711	\$6,071,003 @\$20,510
16	\$7,032,600 @\$23,759	\$6,083,199 @\$20,551
17	\$7,046,700 @\$23,806	\$6,095,396 @\$20,593
18	\$7,060,700 @\$23,854	\$6,107,506 @\$20,633
19	\$7,074,900 @\$23,902	\$6,119,789 @\$20,675
20	\$7,089,000 @\$23,949	\$6,131,985 @\$20,716
21	\$7,110,300 @\$24,021	\$6,150,410 @\$20,778
22	\$7,131,600 @\$24,093	\$6,168,834 @\$20,841
23	\$7,153,000 @\$24,166	\$6,187,345 @\$20,903
25	\$7,174,500 @\$24,238	\$6,205,943 @\$20,966
26	\$7,203,200 @\$24,335	\$6,230,768 @\$21,050
27	\$7,217,600 @\$24,384	\$6,243,224 @\$21,092
28	\$7,232,000 @\$24,432	\$6,255,680 @\$21,134
29	\$7,246,500 @\$24,481	\$6,268,223 @\$21,176
30	\$7,275,500 @\$24,579	\$6,293,308 @\$21,261

B5 : 開放式 240'		
樓層	訂價	折實價13.5%
5	\$5,508,900 @\$22,954	\$4,765,199 @\$19,855
6	\$5,708,700 @\$23,786	\$4,938,026 @\$20,575
7	\$5,785,700 @\$24,107	\$5,004,631 @\$20,853
8	\$5,834,900 @\$24,312	\$5,047,189 @\$21,030
9	\$5,877,200 @\$24,488	\$5,083,778 @\$21,182
10	\$5,894,900 @\$24,562	\$5,099,089 @\$21,246
11	\$5,912,700 @\$24,636	\$5,114,486 @\$21,310

B8 : 2房 460'		
樓層	訂價	折實價13.5%
5	\$9,447,000 @\$20,537	\$8,171,655 @\$17,764
6	\$9,789,600 @\$21,282	\$8,468,004 @\$18,409
7	\$9,911,800 @\$21,547	\$8,573,707 @\$18,638
8	\$10,004,700 @\$21,749	\$8,654,066 @\$18,813
9	\$10,081,300 @\$21,916	\$8,720,325 @\$18,957
10	\$10,111,600 @\$21,982	\$8,746,534 @\$19,014
11	\$10,142,000 @\$22,048	\$8,772,830 @\$19,071
12	\$10,172,600 @\$22,114	\$8,799,299 @\$19,129
15	\$10,192,900 @\$22,158	\$8,816,859 @\$19,167
16	\$10,213,400 @\$22,203	\$8,834,591 @\$19,206
17	\$10,233,800 @\$22,247	\$8,852,237 @\$19,244
18	\$10,254,300 @\$22,292	\$8,869,970 @\$19,283
19	\$10,274,800 @\$22,337	\$8,887,702 @\$19,321
20	\$10,295,400 @\$22,381	\$8,905,521 @\$19,360
21	\$10,326,300 @\$22,448	\$8,932,250 @\$19,418
22	\$10,357,200 @\$22,516	\$8,958,978 @\$19,476
23	\$10,388,300 @\$22,583	\$8,985,880 @\$19,535
25	\$10,419,500 @\$22,651	\$9,012,868 @\$19,593
26	\$10,461,100 @\$22,742	\$9,048,852 @\$19,671
27	\$10,503,000 @\$22,833	\$9,085,095 @\$19,750
28	\$10,545,000 @\$22,924	\$9,121,425 @\$19,829
29	\$10,587,200 @\$23,016	\$9,157,928 @\$19,909
30	\$10,650,700 @\$23,154	\$9,212,856 @\$20,028

Tower 3

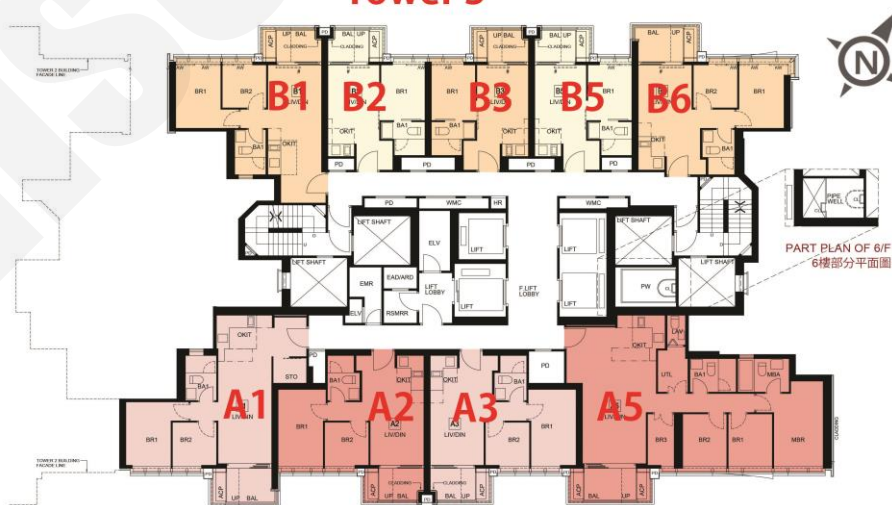

A1 : 2房 559'		
樓層	訂價	折實價13.5%
5	\$11,249,800 @\$20,125	\$9,731,077 @\$17,408
6	\$12,499,800 @\$22,361	\$10,812,327 @\$19,342
27	\$13,943,600 @\$24,944	\$12,061,214 @\$21,576
28	\$14,193,100 @\$25,390	\$12,277,032 @\$21,962
A5 : 3房連套房 887'		
樓層	訂價	折實價13.5%
5	\$11,249,800 @\$20,125	\$9,731,077 @\$17,408