

佳悅

價單1號

以最高6%折扣計算

制作日期: 2022-06-30

A : 1房 199'		
樓層	訂價	折實價6%
25	\$4,510,000 @\$22,663	\$4,239,400 @\$21,304
23	\$4,470,000 @\$22,462	\$4,201,800 @\$21,115
22	\$4,430,000 @\$22,261	\$4,164,200 @\$20,926
21	\$4,390,000 @\$22,060	\$4,126,600 @\$20,737
20	\$4,345,000 @\$21,834	\$4,084,300 @\$20,524
19	\$4,310,000 @\$21,658	\$4,051,400 @\$20,359
18	\$4,265,000 @\$21,432	\$4,009,100 @\$20,146
17	\$4,208,000 @\$21,146	\$3,955,520 @\$19,877
16	\$4,158,000 @\$20,894	\$3,908,520 @\$19,641
15	\$4,105,000 @\$20,628	\$3,858,700 @\$19,390
12	\$4,053,000 @\$20,367	\$3,809,820 @\$19,145
11	\$3,999,000 @\$20,095	\$3,759,060 @\$18,890
10	\$3,947,000 @\$19,834	\$3,710,180 @\$18,644
9	\$3,896,000 @\$19,578	\$3,662,240 @\$18,403
8	\$3,848,000 @\$19,337	\$3,617,120 @\$18,176
7	\$3,785,000 @\$19,020	\$3,557,900 @\$17,879
6	\$3,731,000 @\$18,749	\$3,507,140 @\$17,624
5	\$3,680,000 @\$18,492	\$3,459,200 @\$17,383

C : 開放式 201'		
樓層	訂價	折實價6%
25	\$4,732,000 @\$23,542	\$4,448,080 @\$22,130
23	\$4,683,000 @\$23,299	\$4,402,020 @\$21,901
22	\$4,626,000 @\$23,015	\$4,348,440 @\$21,634
21	\$4,575,000 @\$22,761	\$4,300,500 @\$21,396
20	\$4,523,000 @\$22,502	\$4,251,620 @\$21,152
19	\$4,468,000 @\$22,229	\$4,199,920 @\$20,895
18	\$4,418,000 @\$21,980	\$4,152,920 @\$20,661
17	\$4,378,000 @\$21,781	\$4,115,320 @\$20,474
16	\$4,336,000 @\$21,572	\$4,075,840 @\$20,278
15	\$4,295,000 @\$21,368	\$4,037,300 @\$20,086
12	\$4,256,000 @\$21,174	\$4,000,640 @\$19,904
11	\$4,208,000 @\$20,935	\$3,955,520 @\$19,679
10	\$4,158,000 @\$20,687	\$3,908,520 @\$19,445
9	\$4,116,000 @\$20,478	\$3,869,040 @\$19,249
8	\$4,073,000 @\$20,264	\$3,828,620 @\$19,048
7	\$4,022,000 @\$20,010	\$3,780,680 @\$18,809
6	\$3,980,000 @\$19,801	\$3,741,200 @\$18,613
5	\$3,938,000 @\$19,592	\$3,701,720 @\$18,417

B : 1房 289'		
樓層	訂價	折實價6%
19	\$6,220,000 @\$21,522	\$5,846,800 @\$20,231
10	\$5,816,000 @\$20,125	\$5,467,040 @\$18,917
9	\$5,750,000 @\$19,896	\$5,405,000 @\$18,702
8	\$5,688,000 @\$19,682	\$5,346,720 @\$18,501
7	\$5,616,000 @\$19,433	\$5,279,040 @\$18,267
6	\$5,555,000 @\$19,221	\$5,221,700 @\$18,068
5	\$5,488,000 @\$18,990	\$5,158,720 @\$17,850

D : 1房 283'		
樓層	訂價	折實價6%
19	\$6,248,000 @\$22,078	\$5,873,120 @\$20,753
10	\$5,843,000 @\$20,647	\$5,492,420 @\$19,408
9	\$5,775,000 @\$20,406	\$5,428,500 @\$19,182
8	\$5,712,000 @\$20,184	\$5,369,280 @\$18,973
7	\$5,635,000 @\$19,912	\$5,296,900 @\$18,717
6	\$5,572,000 @\$19,689	\$5,237,680 @\$18,508
5	\$5,510,000 @\$19,470	\$5,179,400 @\$18,302

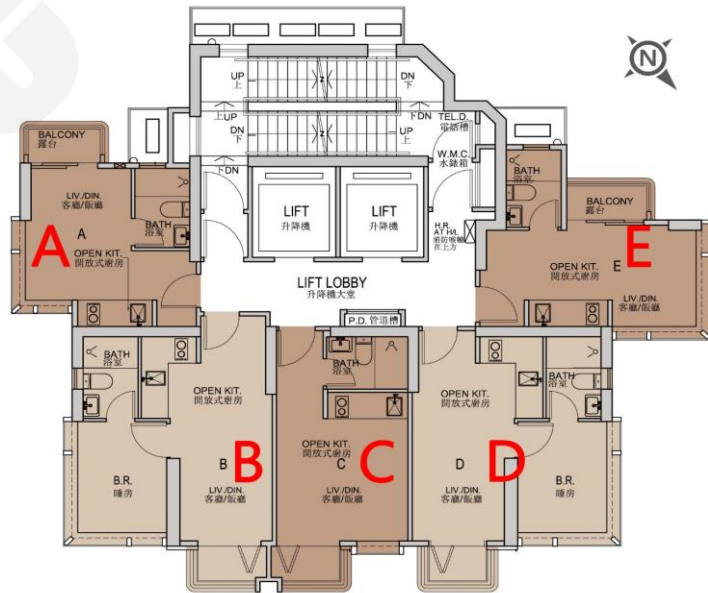

紅色為最高售價、最高平均呎價；藍色為最低售價、最低平均呎價