

柏瓏I

價單1號

以最高16%折扣計算
制作日期: 2022-04-21

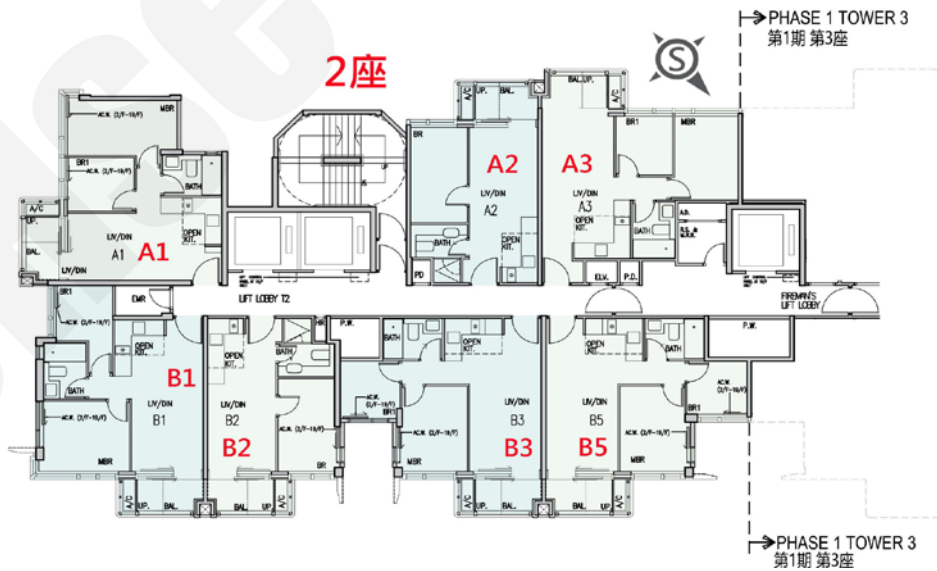

2座B5 : 2房 463'		
樓層	訂價	折實價16%
17	\$9,730,000 @\$21,015	\$8,173,200 @\$17,653
16	\$9,681,000 @\$20,909	\$8,132,040 @\$17,564
15	\$9,633,000 @\$20,806	\$8,091,720 @\$17,477
12	\$9,586,000 @\$20,704	\$8,052,240 @\$17,391
11	\$9,538,000 @\$20,600	\$8,011,920 @\$17,304
10	\$9,492,000 @\$20,501	\$7,973,280 @\$17,221
9	\$9,444,000 @\$20,397	\$7,932,960 @\$17,134
8	\$9,444,000 @\$20,397	\$7,932,960 @\$17,134
7	\$9,351,000 @\$20,197	\$7,854,840 @\$16,965
6	\$9,305,000 @\$20,097	\$7,816,200 @\$16,882
5	\$9,240,000 @\$19,957	\$7,761,600 @\$16,764
3	\$9,177,000 @\$19,821	\$7,708,680 @\$16,649
2	\$9,113,000 @\$19,683	\$7,654,920 @\$16,533
1	\$9,051,000 @\$19,549	\$7,602,840 @\$16,421

2座B3 : 2房 463'		
樓層	訂價	折實價16%
17	\$9,710,000 @\$20,972	\$8,156,400 @\$17,616
16	\$9,662,000 @\$20,868	\$8,116,080 @\$17,529
15	\$9,614,000 @\$20,765	\$8,075,760 @\$17,442
12	\$9,567,000 @\$20,663	\$8,036,280 @\$17,357
11	\$9,519,000 @\$20,559	\$7,995,960 @\$17,270
10	\$9,471,000 @\$20,456	\$7,955,640 @\$17,183
9	\$9,425,000 @\$20,356	\$7,917,000 @\$17,099
8	\$9,425,000 @\$20,356	\$7,917,000 @\$17,099
7	\$9,332,000 @\$20,156	\$7,838,880 @\$16,931
6	\$9,286,000 @\$20,056	\$7,800,240 @\$16,847
5	\$9,221,000 @\$19,916	\$7,745,640 @\$16,729
3	\$9,158,000 @\$19,780	\$7,692,720 @\$16,615
2	\$9,095,000 @\$19,644	\$7,639,800 @\$16,501
1	\$9,032,000 @\$19,508	\$7,586,880 @\$16,386

2座B2 : 1房 354'		
樓層	訂價	折實價16%
16	\$7,786,000 @\$21,994	\$6,540,240 @\$18,475
15	\$7,746,000 @\$21,881	\$6,506,640 @\$18,380
12	\$7,708,000 @\$21,774	\$6,474,720 @\$18,290
11	\$7,669,000 @\$21,664	\$6,441,960 @\$18,198
10	\$7,631,000 @\$21,556	\$6,410,040 @\$18,107
9	\$7,594,000 @\$21,452	\$6,378,960 @\$18,020
8	\$7,594,000 @\$21,452	\$6,378,960 @\$18,020
7	\$7,518,000 @\$21,237	\$6,315,120 @\$17,839
6	\$7,481,000 @\$21,133	\$6,284,040 @\$17,752
5	\$7,429,000 @\$20,986	\$6,240,360 @\$17,628
3	\$7,377,000 @\$20,839	\$6,196,680 @\$17,505
2	\$7,326,000 @\$20,695	\$6,153,840 @\$17,384
1	\$7,238,000 @\$20,446	\$6,079,920 @\$17,175

2座A1 : 2房 472'		
樓層	訂價	折實價16%
16	\$9,652,000 @\$20,449	\$8,107,680 @\$17,177
15	\$9,281,000 @\$19,663	\$7,796,040 @\$16,517
12	\$9,235,000 @\$19,566	\$7,757,400 @\$16,435
11	\$9,189,000 @\$19,468	\$7,718,760 @\$16,353
10	\$9,143,000 @\$19,371	\$7,680,120 @\$16,271
9	\$9,098,000 @\$19,275	\$7,642,320 @\$16,191
8	\$9,098,000 @\$19,275	\$7,642,320 @\$16,191
7	\$9,007,000 @\$19,083	\$7,565,880 @\$16,029
6	\$9,004,000 @\$19,076	\$7,563,360 @\$16,024
5	\$9,002,000 @\$19,072	\$7,561,680 @\$16,021
3	\$9,000,000 @\$19,068	\$7,560,000 @\$16,017
2	\$8,998,000 @\$19,064	\$7,558,320 @\$16,013
1	\$8,995,000 @\$19,057	\$7,555,800 @\$16,008

2座A3 : 2房 455'		
樓層	訂價	折實價16%
15	\$10,294,000 @\$22,624	\$8,646,960 @\$19,004
12	\$10,252,000 @\$22,532	\$8,611,680 @\$18,927
11	\$10,212,000 @\$22,444	\$8,578,080 @\$18,853
10	\$10,171,000 @\$22,354	\$8,543,640 @\$18,777
9	\$10,131,000 @\$22,266	\$8,510,040 @\$18,703
8	\$10,131,000 @\$22,266	\$8,510,040 @\$18,703
7	\$10,050,000 @\$22,088	\$8,442,000 @\$18,554
6	\$10,011,000 @\$22,002	\$8,409,240 @\$18,482
5	\$9,990,000 @\$21,956	\$8,391,600 @\$18,443

紅色為最高售價、最高平均呎價；藍色為最低售價、最低平均呎價

柏瓏I

價單1號

以最高16%折扣計算

制作日期: 2022-04-21



3座A5: 2房 474'

樓層	訂價	折實價16%
15	\$10,644,000 @\$22,456	\$8,940,960 @\$18,863
12	\$10,601,000 @\$22,365	\$8,904,840 @\$18,787
11	\$10,558,000 @\$22,274	\$8,868,720 @\$18,710
10	\$10,517,000 @\$22,188	\$8,834,280 @\$18,638
9	\$10,474,000 @\$22,097	\$8,798,160 @\$18,562
8	\$10,474,000 @\$22,097	\$8,798,160 @\$18,562
7	\$10,389,000 @\$21,918	\$8,726,760 @\$18,411
6	\$10,348,000 @\$21,831	\$8,692,320 @\$18,338
5	\$10,327,000 @\$21,787	\$8,674,680 @\$18,301

3座A2: 3房連套房及儲物室 727'

樓層	訂價	折實價16%
15	\$15,612,000 @\$21,475	\$13,114,080 @\$18,039
12	\$15,550,000 @\$21,389	\$13,062,000 @\$17,967
11	\$15,489,000 @\$21,305	\$13,010,760 @\$17,897
10	\$15,427,000 @\$21,220	\$12,958,680 @\$17,825
9	\$15,367,000 @\$21,138	\$12,908,280 @\$17,756
8	\$15,367,000 @\$21,138	\$12,908,280 @\$17,756
7	\$15,245,000 @\$20,970	\$12,805,800 @\$17,615
6	\$15,186,000 @\$20,889	\$12,756,240 @\$17,546
5	\$15,156,000 @\$20,847	\$12,731,040 @\$17,512

紅色為最高售價、最高平均呎價；藍色為最低售價、最低平均呎價

柏瓏I

價單1號

以最高16%折扣計算
制作日期: 2022-04-21



5座B8: 1房 354'		
樓層	訂價	折實價16%
16	\$7,967,000 @\$22,506	\$6,692,280 @\$18,905
15	\$7,927,000 @\$22,393	\$6,658,680 @\$18,810
12	\$7,887,000 @\$22,280	\$6,625,080 @\$18,715
11	\$7,846,000 @\$22,164	\$6,590,640 @\$18,618
10	\$7,807,000 @\$22,054	\$6,557,880 @\$18,525
9	\$7,768,000 @\$21,944	\$6,525,120 @\$18,433
8	\$7,768,000 @\$21,944	\$6,525,120 @\$18,433
7	\$7,689,000 @\$21,720	\$6,458,760 @\$18,245
6	\$7,651,000 @\$21,613	\$6,426,840 @\$18,155
5	\$7,596,000 @\$21,458	\$6,380,640 @\$18,024
3	\$7,543,000 @\$21,308	\$6,336,120 @\$17,899
2	\$7,490,000 @\$21,158	\$6,291,600 @\$17,773
1	\$7,437,000 @\$21,008	\$6,247,080 @\$17,647

5座B7: 2房 464'		
樓層	訂價	折實價16%
16	\$9,820,000 @\$21,164	\$8,248,800 @\$17,778
15	\$9,771,000 @\$21,058	\$8,207,640 @\$17,689
12	\$9,723,000 @\$20,955	\$8,167,320 @\$17,602
11	\$9,674,000 @\$20,849	\$8,126,160 @\$17,513
10	\$9,626,000 @\$20,746	\$8,085,840 @\$17,426
9	\$9,579,000 @\$20,644	\$8,046,360 @\$17,341
8	\$9,579,000 @\$20,644	\$8,046,360 @\$17,341
7	\$9,483,000 @\$20,438	\$7,965,720 @\$17,168
6	\$9,436,000 @\$20,336	\$7,926,240 @\$17,082
5	\$9,370,000 @\$20,194	\$7,870,800 @\$16,963
3	\$9,305,000 @\$20,054	\$7,816,200 @\$16,845
2	\$9,240,000 @\$19,914	\$7,761,600 @\$16,728
1	\$9,176,000 @\$19,776	\$7,707,840 @\$16,612

5座B6: 2房 464'		
樓層	訂價	折實價16%
16	\$9,800,000 @\$21,121	\$8,232,000 @\$17,741
15	\$9,751,000 @\$21,015	\$8,190,840 @\$17,653
12	\$9,702,000 @\$20,909	\$8,149,680 @\$17,564
11	\$9,655,000 @\$20,808	\$8,110,200 @\$17,479
10	\$9,607,000 @\$20,705	\$8,069,880 @\$17,392
9	\$9,558,000 @\$20,599	\$8,028,720 @\$17,303
8	\$9,558,000 @\$20,599	\$8,028,720 @\$17,303
7	\$9,464,000 @\$20,397	\$7,949,760 @\$17,133
6	\$9,417,000 @\$20,295	\$7,910,280 @\$17,048
5	\$9,351,000 @\$20,153	\$7,854,840 @\$16,929
3	\$9,287,000 @\$20,015	\$7,801,080 @\$16,813
2	\$9,223,000 @\$19,877	\$7,747,320 @\$16,697
1	\$9,158,000 @\$19,737	\$7,692,720 @\$16,579

5座B5: 1房及儲物室 384'		
樓層	訂價	折實價16%
16	\$8,556,000 @\$22,281	\$7,187,040 @\$18,716
15	\$8,514,000 @\$22,172	\$7,151,760 @\$18,624
12	\$8,471,000 @\$22,060	\$7,115,640 @\$18,530
11	\$8,430,000 @\$21,953	\$7,081,200 @\$18,441
10	\$8,387,000 @\$21,841	\$7,045,080 @\$18,347
9	\$8,345,000 @\$21,732	\$7,009,800 @\$18,255
8	\$8,345,000 @\$21,732	\$7,009,800 @\$18,255
7	\$8,263,000 @\$21,518	\$6,940,920 @\$18,075
6	\$8,221,000 @\$21,409	\$6,905,640 @\$17,983
5	\$8,164,000 @\$21,260	\$6,857,760 @\$17,859
3	\$8,108,000 @\$21,115	\$6,810,720 @\$17,736
2	\$8,051,000 @\$20,966	\$6,762,840 @\$17,612
1	\$7,995,000 @\$20,820	\$6,715,800 @\$17,489

5座A5: 3房連套房及工人套房 762'		
樓層	訂價	折實價16%
15	\$16,660,000 @\$21,864	\$13,994,400 @\$18,365
12	\$16,593,000 @\$21,776	\$13,938,120 @\$18,291
11	\$16,526,000 @\$21,688	\$13,881,840 @\$18,218
10	\$16,461,000 @\$21,602	\$13,827,240 @\$18,146
9	\$16,395,000 @\$21,516	\$13,771,800 @\$18,073
8	\$16,395,000 @\$21,516	\$13,771,800 @\$18,073
7	\$16,264,000 @\$21,344	\$13,661,760 @\$17,929
6	\$16,199,000 @\$21,259	\$13,607,160 @\$17,857
5	\$16,167,000 @\$21,217	\$13,580,280 @\$17,822
5	\$8,164,000 @\$21,260	\$6,857,760 @\$17,859

5座B3: 1房及儲物室 382'		
樓層	訂價	折實價16%
16	\$8,492,000 @\$22,230	\$7,133,280 @\$18,674
15	\$8,449,000 @\$22,118	\$7,097,160 @\$18,579
12	\$8,407,000 @\$22,008	\$7,061,880 @\$18,487
11	\$8,365,000 @\$21,898	\$7,026,600 @\$18,394
10	\$8,324,000 @\$21,791	\$6,992,160 @\$18,304
9	\$8,282,000 @\$21,681	\$6,956,880 @\$18,212
8	\$8,282,000 @\$21,681	\$6,956,880 @\$18,212
7	\$8,200,000 @\$21,466	\$6,888,000 @\$18,031
6	\$8,160,000 @\$21,361	\$6,854,400 @\$17,943
5	\$8,102,000 @\$21,209	\$6,805,680 @\$17,816
3	\$8,046,000 @\$21,063	\$6,758,640 @\$17,693
2	\$7,990,000 @\$20,916	\$6,711,600 @\$17,570
1	\$7,935,000 @\$20,772	\$6,665,400 @\$17,449

5座B2: 2房及儲物室 547/557'		
樓層	訂價	折實價16%
16	\$11,399,000 @\$20,839	\$9,575,160 @\$17,505
15	\$11,370,000 @\$20,786	\$9,550,800 @\$17,460
12	\$11,343,000 @\$20,737	\$9,528,120 @\$17,419
11	\$11,314,000 @\$20,684	\$9,503,760 @\$17,374
10	\$11,287,000 @\$20,634	\$9,481,080 @\$17,333
9	\$11,260,000 @\$20,585	\$9,458,400 @\$17,291
8	\$11,260,000 @\$20,585	\$9,458,400 @\$17,291
7	\$11,204,000 @\$20,483	\$9,411,360 @\$17,205
6	\$11,176,000 @\$20,431	\$9,387,840 @\$17,162
5	\$11,132,000 @\$20,351	\$9,350,880 @\$17,095
3	\$11,088,000 @\$20,271	\$9,313,920 @\$17,027
2	\$11,044,000 @\$20,190	\$9,276,960 @\$16,960
1	\$11,200,000 @\$20,108	\$9,408,000 @\$16,890

紅色為最高售價、最高平均呎價；藍色為最低售價、最低平均呎價