

1A座G: 1房 326'		
樓層	訂價	折實價12%
38	\$9,863,000 @ \$30,255	\$8,679,440 @ \$26,624
37	\$9,843,000 @ \$30,193	\$8,661,840 @ \$26,570
36	\$9,824,000 @ \$30,135	\$8,645,120 @ \$26,519
35	\$9,809,000 @ \$30,089	\$8,631,920 @ \$26,478
33	\$9,796,000 @ \$30,049	\$8,620,480 @ \$26,443
32	\$9,781,000 @ \$30,003	\$8,607,280 @ \$26,403
31	\$9,766,000 @ \$29,957	\$8,594,080 @ \$26,362
30	\$9,747,000 @ \$29,899	\$8,577,360 @ \$26,311
29	\$9,726,000 @ \$29,834	\$8,558,880 @ \$26,254
28	\$9,701,000 @ \$29,758	\$8,536,880 @ \$26,187
27	\$9,677,000 @ \$29,684	\$8,515,760 @ \$26,122
26	\$9,652,000 @ \$29,607	\$8,493,760 @ \$26,054
25	\$9,633,000 @ \$29,549	\$8,477,040 @ \$26,003
23	\$9,612,000 @ \$29,485	\$8,458,560 @ \$25,947
22	\$9,582,000 @ \$29,393	\$8,432,160 @ \$25,866
21	\$9,532,000 @ \$29,239	\$8,388,160 @ \$25,731
20	\$9,513,000 @ \$29,181	\$8,371,440 @ \$25,679
19	\$9,494,000 @ \$29,123	\$8,354,720 @ \$25,628
18	\$9,475,000 @ \$29,064	\$8,338,000 @ \$25,577
17	\$9,436,000 @ \$28,945	\$8,303,680 @ \$25,471
16	\$9,412,000 @ \$28,871	\$8,282,560 @ \$25,407
15	\$9,411,000 @ \$28,868	\$8,281,680 @ \$25,404
12	\$9,410,000 @ \$28,865	\$8,280,800 @ \$25,401
11	\$9,405,000 @ \$28,850	\$8,276,400 @ \$25,388
10	\$9,403,000 @ \$28,844	\$8,274,640 @ \$25,382
9	\$9,402,000 @ \$28,840	\$8,273,760 @ \$25,380
8	\$9,392,000 @ \$28,810	\$8,264,960 @ \$25,353
7	\$9,371,000 @ \$28,745	\$8,246,840 @ \$25,296
6	\$9,369,000 @ \$28,739	\$8,244,720 @ \$25,291
5	\$9,368,000 @ \$28,736	\$8,243,840 @ \$25,288

1A座F: 2房 440'		
樓層	訂價	折實價12%
38	\$13,017,000 @ \$29,584	\$11,454,960 @ \$26,034
37	\$12,940,000 @ \$29,409	\$11,387,200 @ \$25,880
36	\$12,901,000 @ \$29,320	\$11,352,880 @ \$25,802
35	\$12,862,000 @ \$29,232	\$11,318,560 @ \$25,724
33	\$12,824,000 @ \$29,145	\$11,285,120 @ \$25,648
32	\$12,785,000 @ \$29,057	\$11,250,800 @ \$25,570
31	\$12,747,000 @ \$28,970	\$11,217,360 @ \$25,494
30	\$12,709,000 @ \$28,884	\$11,183,920 @ \$25,418
29	\$12,671,000 @ \$28,798	\$11,150,480 @ \$25,342
28	\$12,633,000 @ \$28,711	\$11,117,040 @ \$25,266
27	\$12,543,000 @ \$28,507	\$11,037,840 @ \$25,086
26	\$12,505,000 @ \$28,420	\$11,004,400 @ \$25,010
25	\$12,468,000 @ \$28,336	\$10,971,840 @ \$24,936
23	\$12,431,000 @ \$28,252	\$10,939,280 @ \$24,862
22	\$12,394,000 @ \$28,168	\$10,906,720 @ \$24,788
21	\$12,356,000 @ \$28,082	\$10,873,280 @ \$24,712
20	\$12,319,000 @ \$27,998	\$10,840,720 @ \$24,638
19	\$12,283,000 @ \$27,916	\$10,809,040 @ \$24,566
18	\$12,246,000 @ \$27,832	\$10,776,480 @ \$24,492
17	\$12,173,000 @ \$27,666	\$10,712,240 @ \$24,346
16	\$12,122,000 @ \$27,550	\$10,667,360 @ \$24,244
15	\$12,071,000 @ \$27,434	\$10,622,480 @ \$24,142
12	\$12,035,000 @ \$27,352	\$10,590,800 @ \$24,070
11	\$11,999,000 @ \$27,270	\$10,559,120 @ \$23,998
10	\$11,963,000 @ \$27,189	\$10,527,440 @ \$23,926
9	\$11,928,000 @ \$27,109	\$10,496,640 @ \$23,856
8	\$11,892,000 @ \$27,027	\$10,464,960 @ \$23,784
7	\$11,821,000 @ \$26,866	\$10,402,480 @ \$23,642
6	\$11,786,000 @ \$26,786	\$10,371,680 @ \$23,572
5	\$11,750,000 @ \$26,705	\$10,340,000 @ \$23,500

1A座E: 2房 437/438/448'		
樓層	訂價	折實價12%
38	\$12,928,000 @ \$29,584	\$11,376,640 @ \$26,034
37	\$12,881,000 @ \$29,409	\$11,335,280 @ \$25,880
36	\$12,842,000 @ \$29,320	\$11,300,960 @ \$25,801
35	\$12,804,000 @ \$29,233	\$11,267,520 @ \$25,725
33	\$12,766,000 @ \$29,146	\$11,234,080 @ \$25,649
32	\$12,727,000 @ \$29,057	\$11,199,760 @ \$25,570
31	\$12,689,000 @ \$28,970	\$11,166,320 @ \$25,494
30	\$12,651,000 @ \$28,884	\$11,132,880 @ \$25,418
29	\$12,614,000 @ \$28,799	\$11,100,320 @ \$25,343
28	\$12,576,000 @ \$28,712	\$11,066,880 @ \$25,267
27	\$12,486,000 @ \$28,507	\$10,987,680 @ \$25,086
26	\$12,449,000 @ \$28,422	\$10,955,120 @ \$25,012
25	\$12,411,000 @ \$28,336	\$10,921,680 @ \$24,935
23	\$12,374,000 @ \$28,251	\$10,889,120 @ \$24,861
22	\$12,337,000 @ \$28,167	\$10,856,560 @ \$24,787
21	\$12,300,000 @ \$28,082	\$10,824,000 @ \$24,712
20	\$12,263,000 @ \$27,998	\$10,791,440 @ \$24,638
19	\$12,227,000 @ \$27,916	\$10,759,760 @ \$24,566
18	\$12,190,000 @ \$27,831	\$10,727,200 @ \$24,491
17	\$12,118,000 @ \$27,667	\$10,663,840 @ \$24,347
16	\$12,067,000 @ \$27,550	\$10,618,960 @ \$24,244
15	\$12,016,000 @ \$27,434	\$10,574,080 @ \$24,142
12	\$11,980,000 @ \$27,352	\$10,542,400 @ \$24,069
11	\$11,945,000 @ \$27,272	\$10,511,600 @ \$23,999
10	\$11,909,000 @ \$27,189	\$10,479,920 @ \$23,927
9	\$11,873,000 @ \$27,107	\$10,448,240 @ \$23,854
8	\$11,838,000 @ \$27,027	\$10,417,440 @ \$23,784
7	\$11,767,000 @ \$26,865	\$10,354,960 @ \$23,641
6	\$11,732,000 @ \$26,785	\$10,324,160 @ \$23,571
5	\$11,958,000 @ \$26,692	\$10,523,040 @ \$23,489

1A座D: 2房 442/443'		
樓層	訂價	折實價12%
38	\$12,926,000 @ \$29,244	\$11,374,880 @ \$25,735
37	\$12,904,000 @ \$29,129	\$11,355,520 @ \$25,633
36	\$12,878,000 @ \$29,070	\$11,332,640 @ \$25,582
35	\$12,852,000 @ \$29,011	\$11,309,760 @ \$25,530
33	\$12,826,000 @ \$28,953	\$11,286,880 @ \$25,478
32	\$12,801,000 @ \$28,896	\$11,264,880 @ \$25,429
31	\$12,775,000 @ \$28,837	\$11,242,000 @ \$25,377
30	\$12,750,000 @ \$28,781	\$11,220,000 @ \$25,327
29	\$12,724,000 @ \$28,722	\$11,197,120 @ \$25,276
28	\$12,686,000 @ \$28,637	\$11,163,680 @ \$25,200
27	\$12,623,000 @ \$28,494	\$11,108,240 @ \$25,075
26	\$12,592,000 @ \$28,424	\$11,080,960 @ \$25,013
25	\$12,560,000 @ \$28,352	\$11,052,800 @ \$24,950
23	\$12,529,000 @ \$28,282	\$11,025,520 @ \$24,888
22	\$12,498,000 @ \$28,212	\$10,998,240 @ \$24,827
21	\$12,430,000 @ \$28,059	\$10,938,400 @ \$24,692
20	\$12,399,000 @ \$27,989	\$10,911,120 @ \$24,630
19	\$12,380,000 @ \$27,946	\$10,894,400 @ \$24,592
18	\$12,361,000 @ \$27,903	\$10,877,680 @ \$24,555
17	\$12,294,000 @ \$27,752	\$10,818,720 @ \$24,421
16	\$12,248,000 @ \$27,648	\$10,778,240 @ \$24,330
15	\$12,218,000 @ \$27,580	\$10,751,840 @ \$24,271
12	\$12,181,000 @ \$27,497	\$10,719,280 @ \$24,197
11	\$12,145,000 @ \$27,415	\$10,687,600 @ \$24,126
10	\$12,120,000 @ \$27,359	\$10,665,600 @ \$24,076
9	\$12,084,000 @ \$27,278	\$10,633,920 @ \$24,004
8	\$12,048,000 @ \$27,196	\$10,602,240 @ \$23,933
7	\$11,976,000 @ \$27,034	\$10,538,880 @ \$23,790
6	\$11,940,000 @ \$26,953	\$10,507,200 @ \$23,718

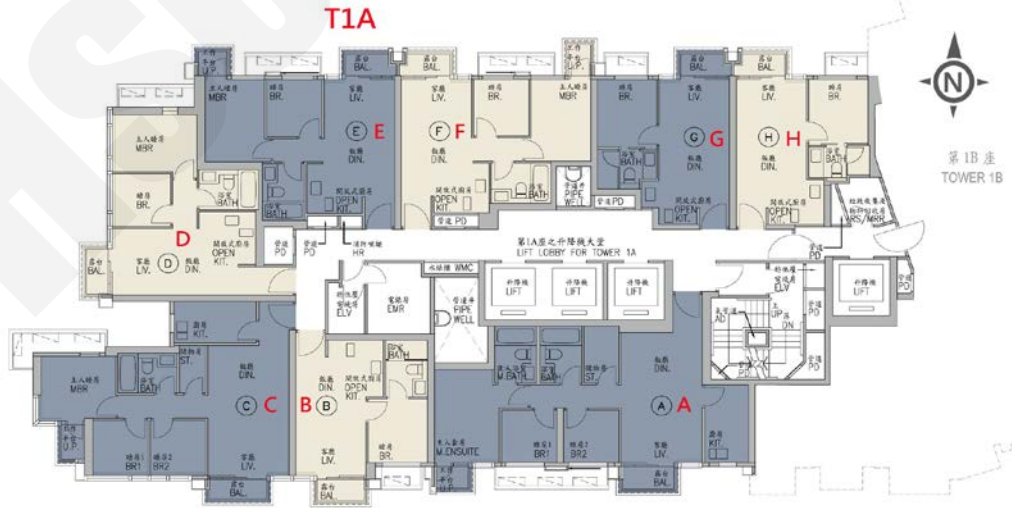

紅色為最高售價、最高平均呎價；藍色為最低售價、最低平均呎價

以上的物業資料只供參考，一切以發展商最新公布為準，如有任何資料錯漏本網頁不會承擔任何責任。

1A座A: 3房連套房及儲物房 713'		
樓層	訂價	折實價12%
37	\$23,188,000 @\$32,522	\$20,405,440 @\$28,619
36	\$23,119,000 @\$32,425	\$20,344,720 @\$28,534
35	\$23,050,000 @\$32,328	\$20,284,000 @\$28,449
33	\$22,981,000 @\$32,231	\$20,223,280 @\$28,364
32	\$22,912,000 @\$32,135	\$20,162,560 @\$28,278
31	\$22,844,000 @\$32,039	\$20,102,720 @\$28,195
30	\$22,775,000 @\$31,942	\$20,042,000 @\$28,109
29	\$22,707,000 @\$31,847	\$19,982,160 @\$28,025
28	\$22,639,000 @\$31,752	\$19,922,320 @\$27,942
27	\$22,570,000 @\$31,657	\$19,862,480 @\$27,857
26	\$22,502,000 @\$31,562	\$19,802,640 @\$27,772
25	\$22,434,000 @\$31,467	\$19,742,800 @\$27,687
23	\$22,303,000 @\$31,281	\$19,626,640 @\$27,527
22	\$22,236,000 @\$31,187	\$19,567,680 @\$27,444
21	\$22,170,000 @\$31,094	\$19,509,600 @\$27,363
20	\$22,104,000 @\$31,001	\$19,451,520 @\$27,281
19	\$22,038,000 @\$30,908	\$19,393,440 @\$27,199
18	\$21,972,000 @\$30,815	\$19,335,360 @\$27,117
17	\$21,906,000 @\$30,722	\$19,277,280 @\$27,035
16	\$21,840,000 @\$30,629	\$19,219,200 @\$26,953
15	\$21,774,000 @\$30,536	\$19,161,120 @\$26,871
12	\$21,642,000 @\$30,328	\$19,029,120 @\$26,689
11	\$20,970,000 @\$29,411	\$18,453,600 @\$25,882
10	\$20,519,000 @\$28,778	\$18,056,720 @\$25,325
9	\$20,276,000 @\$28,438	\$17,842,880 @\$25,025
8	\$19,986,000 @\$28,031	\$17,587,680 @\$24,667
7	\$19,975,000 @\$28,015	\$17,578,000 @\$24,654
6	\$19,263,000 @\$27,017	\$16,951,440 @\$23,775
5	\$19,205,000 @\$26,935	\$16,900,400 @\$23,703
3	\$19,148,000 @\$26,856	\$16,850,240 @\$23,633



1A座H: 1房 328'		
樓層	訂價	折實價12%
35	\$9,857,000 @\$30,052	\$8,674,160 @\$26,446
33	\$9,846,000 @\$30,018	\$8,664,480 @\$26,416
31	\$9,822,000 @\$29,945	\$8,643,360 @\$26,352
30	\$9,807,000 @\$29,899	\$8,630,160 @\$26,311
29	\$9,793,000 @\$29,857	\$8,617,840 @\$26,274
27	\$9,753,000 @\$29,735	\$8,582,640 @\$26,167
26	\$9,734,000 @\$29,677	\$8,565,920 @\$26,116
25	\$9,708,000 @\$29,598	\$8,543,040 @\$26,046
23	\$9,684,000 @\$29,524	\$8,521,920 @\$25,981
22	\$9,644,000 @\$29,402	\$8,486,720 @\$25,874
21	\$9,591,000 @\$29,241	\$8,440,080 @\$25,732
20	\$9,571,000 @\$29,180	\$8,422,480 @\$25,678
19	\$9,552,000 @\$29,122	\$8,405,760 @\$25,627
18	\$9,533,000 @\$29,064	\$8,389,040 @\$25,576
17	\$9,512,000 @\$29,000	\$8,370,560 @\$25,520
16	\$9,470,000 @\$28,872	\$8,333,600 @\$25,407
15	\$9,469,000 @\$28,869	\$8,332,720 @\$25,405
12	\$9,468,000 @\$28,866	\$8,331,840 @\$25,402
11	\$9,462,000 @\$28,848	\$8,326,560 @\$25,386
10	\$9,461,000 @\$28,845	\$8,325,680 @\$25,383
9	\$9,460,000 @\$28,841	\$8,324,800 @\$25,380
8	\$9,449,000 @\$28,808	\$8,315,120 @\$25,351
7	\$9,428,000 @\$28,744	\$8,296,640 @\$25,295
6	\$9,427,000 @\$28,741	\$8,295,760 @\$25,292
5	\$9,425,000 @\$28,735	\$8,294,000 @\$25,287

1A座C: 3房及儲物房 616/623'		
樓層	訂價	折實價12%
30	\$19,630,000 @\$31,867	\$17,274,400 @\$28,043
29	\$19,571,000 @\$31,771	\$17,222,480 @\$27,959
28	\$19,513,000 @\$31,677	\$17,171,440 @\$27,876
27	\$19,396,000 @\$31,487	\$17,068,480 @\$27,709
26	\$19,338,000 @\$31,393	\$17,017,440 @\$27,626
25	\$19,280,000 @\$31,299	\$16,966,400 @\$27,543
23	\$19,223,000 @\$31,206	\$16,916,240 @\$27,461
22	\$19,165,000 @\$31,112	\$16,865,200 @\$27,379
21	\$19,108,000 @\$31,019	\$16,815,040 @\$27,297
20	\$19,051,000 @\$30,927	\$16,764,880 @\$27,216
19	\$18,994,000 @\$30,834	\$16,714,720 @\$27,134
18	\$18,937,000 @\$30,742	\$16,664,560 @\$27,053
17	\$18,824,000 @\$30,558	\$16,565,120 @\$26,891
16	\$18,630,000 @\$30,244	\$16,394,400 @\$26,614
15	\$18,666,000 @\$30,302	\$16,426,080 @\$26,666
12	\$18,610,000 @\$30,211	\$16,376,800 @\$26,586
11	\$18,102,000 @\$29,386	\$15,929,760 @\$25,860
10	\$17,695,000 @\$28,726	\$15,571,600 @\$25,279
9	\$17,503,000 @\$28,414	\$15,402,640 @\$25,004
8	\$17,244,000 @\$27,994	\$15,174,720 @\$24,634
7	\$17,023,000 @\$27,635	\$14,980,240 @\$24,319
6	\$16,640,000 @\$27,013	\$14,643,200 @\$23,771
5	\$16,779,000 @\$26,933	\$14,765,520 @\$23,701
3	\$16,729,000 @\$26,852	\$14,721,520 @\$23,630
5	\$9,425,000 @\$28,735	\$8,294,000 @\$25,287

1A座B: 1房 326'		
樓層	訂價	折實價12%
28	\$10,571,000 @\$32,426	\$9,302,480 @\$28,535
25	\$10,470,000 @\$32,117	\$9,213,600 @\$28,263
23	\$10,439,000 @\$32,021	\$9,186,320 @\$28,179
21	\$10,376,000 @\$31,828	\$9,130,880 @\$28,009
20	\$10,345,000 @\$31,733	\$9,103,600 @\$27,925
19	\$10,314,000 @\$31,638	\$9,076,320 @\$27,841
18	\$10,284,000 @\$31,546	\$9,049,920 @\$27,760
17	\$10,222,000 @\$31,356	\$8,995,360 @\$27,593
16	\$10,167,000 @\$31,187	\$8,946,960 @\$27,445
15	\$10,161,000 @\$31,169	\$8,941,680 @\$27,428
12	\$10,131,000 @\$31,077	\$8,915,280 @\$27,347
11	\$9,903,000 @\$30,377	\$8,714,640 @\$26,732
10	\$9,680,000 @\$29,693	\$8,518,400 @\$26,130
9	\$9,556,000 @\$29,313	\$8,409,280 @\$25,795
8	\$9,434,000 @\$28,939	\$8,301,920 @\$25,466
7	\$9,312,000 @\$28,564	\$8,194,560 @\$25,137
6	\$9,103,000 @\$27,923	\$8,010,640 @\$24,573
5	\$9,076,000 @\$27,840	\$7,986,880 @\$24,500
3	\$9,049,000 @\$27,758	\$7,963,120 @\$24,427

紅色為最高售價、最高平均呎價；藍色為最低售價、最低平均呎價

以上的物業資料只供參考，一切以發展商最新公布為準，如有任何資料錯漏本網頁不會承擔任何責任。

1B座G : 2房 455'/462'

樓層	訂價	折實價12%
38	\$13,372,000 @ \$29,389	\$11,767,360 @ \$25,862
37	\$13,317,000 @ \$29,268	\$11,718,960 @ \$25,756
36	\$13,482,000 @ \$29,182	\$11,864,160 @ \$25,680
35	\$13,441,000 @ \$29,093	\$11,828,080 @ \$25,602
33	\$13,401,000 @ \$29,006	\$11,792,880 @ \$25,526
32	\$13,361,000 @ \$28,920	\$11,757,680 @ \$25,450
31	\$13,321,000 @ \$28,833	\$11,722,480 @ \$25,373
30	\$13,281,000 @ \$28,747	\$11,687,280 @ \$25,297
29	\$13,242,000 @ \$28,662	\$11,652,960 @ \$25,223
28	\$13,202,000 @ \$28,576	\$11,617,760 @ \$25,147
27	\$13,123,000 @ \$28,405	\$11,548,240 @ \$24,996
26	\$13,084,000 @ \$28,320	\$11,513,920 @ \$24,922
25	\$13,045,000 @ \$28,236	\$11,479,600 @ \$24,848
23	\$12,981,000 @ \$28,097	\$11,423,280 @ \$24,726
22	\$12,918,000 @ \$27,961	\$11,367,840 @ \$24,606
21	\$12,830,000 @ \$27,771	\$11,290,400 @ \$24,438
20	\$12,742,000 @ \$27,580	\$11,212,960 @ \$24,270
19	\$12,655,000 @ \$27,392	\$11,136,400 @ \$24,105
18	\$12,641,000 @ \$27,361	\$11,124,080 @ \$24,078
17	\$12,615,000 @ \$27,305	\$11,101,200 @ \$24,029
16	\$12,586,000 @ \$27,242	\$11,075,680 @ \$23,973
15	\$12,557,000 @ \$27,180	\$11,050,160 @ \$23,918
12	\$12,544,000 @ \$27,152	\$11,038,720 @ \$23,893
11	\$12,530,000 @ \$27,121	\$11,026,400 @ \$23,867
10	\$12,517,000 @ \$27,093	\$11,014,960 @ \$23,842
9	\$12,503,000 @ \$27,063	\$11,002,640 @ \$23,815
8	\$12,490,000 @ \$27,035	\$10,991,200 @ \$23,790
7	\$12,439,000 @ \$26,924	\$10,946,320 @ \$23,693
6	\$12,425,000 @ \$26,894	\$10,934,000 @ \$23,667
5	\$12,388,000 @ \$26,814	\$10,901,440 @ \$23,596
1B座B : 3房 574'		
樓層	訂價	折實價12%
23	\$18,039,000 @ \$31,427	\$15,874,320 @ \$27,656
22	\$17,985,000 @ \$31,333	\$15,826,800 @ \$27,573
20	\$17,856,000 @ \$31,108	\$15,713,280 @ \$27,375
19	\$17,803,000 @ \$31,016	\$15,666,640 @ \$27,294
18	\$17,767,000 @ \$30,953	\$15,634,960 @ \$27,239
17	\$17,665,000 @ \$30,775	\$15,545,200 @ \$27,082
15	\$17,516,000 @ \$30,516	\$15,414,080 @ \$26,854
12	\$17,463,000 @ \$30,423	\$15,367,440 @ \$26,773
11	\$17,071,000 @ \$29,740	\$15,022,480 @ \$26,172
10	\$16,687,000 @ \$29,071	\$14,684,560 @ \$25,583
9	\$16,538,000 @ \$28,812	\$14,553,440 @ \$25,354
8	\$16,323,000 @ \$28,437	\$14,364,240 @ \$25,025
7	\$16,093,000 @ \$28,037	\$14,161,840 @ \$24,672
6	\$15,696,000 @ \$27,345	\$13,812,480 @ \$24,064
5	\$15,650,000 @ \$27,265	\$13,772,000 @ \$23,993
3	\$15,603,000 @ \$27,183	\$13,730,640 @ \$23,921

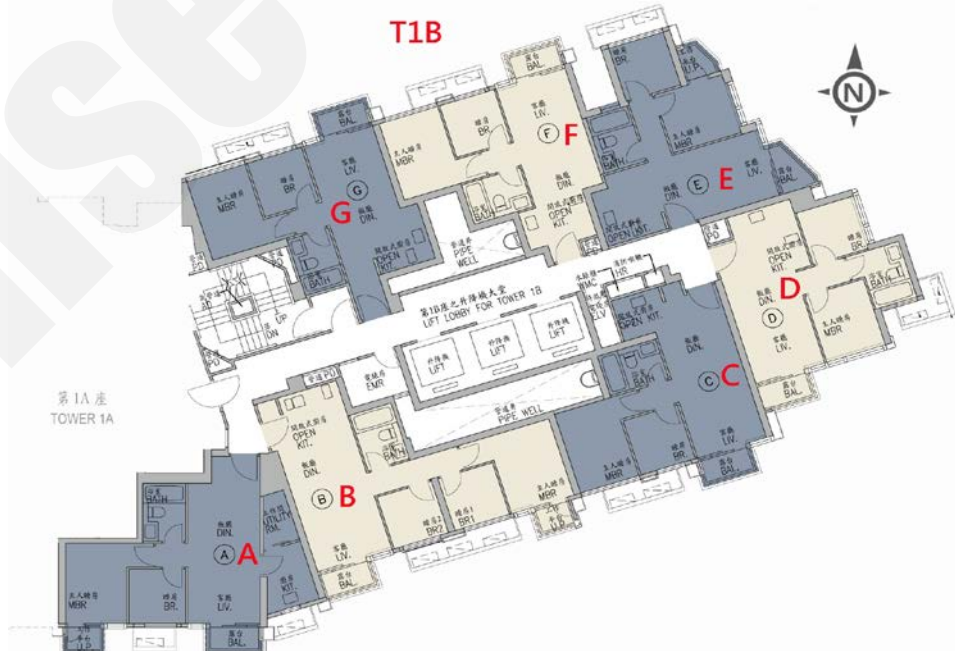

1B座A : 2房 525'

樓層	訂價	折實價12%
37	\$17,195,000 @ \$32,752	\$15,131,600 @ \$28,822
36	\$17,193,000 @ \$32,749	\$15,129,840 @ \$28,819
35	\$17,191,000 @ \$32,745	\$15,128,080 @ \$28,815
33	\$17,157,000 @ \$32,680	\$15,098,160 @ \$28,758
32	\$17,139,000 @ \$32,646	\$15,082,320 @ \$28,728
31	\$17,105,000 @ \$32,581	\$15,052,400 @ \$28,671
30	\$17,070,000 @ \$32,514	\$15,021,600 @ \$28,613
29	\$17,036,000 @ \$32,450	\$14,991,680 @ \$28,556
28	\$17,002,000 @ \$32,385	\$14,961,760 @ \$28,499
27	\$16,898,000 @ \$32,187	\$14,870,240 @ \$28,324
26	\$16,856,000 @ \$32,107	\$14,833,280 @ \$28,254
25	\$16,734,000 @ \$31,874	\$14,725,920 @ \$28,049
23	\$16,613,000 @ \$31,644	\$14,619,440 @ \$27,847
22	\$16,532,000 @ \$31,490	\$14,548,160 @ \$27,711
21	\$16,412,000 @ \$31,261	\$14,442,560 @ \$27,510
20	\$16,293,000 @ \$31,034	\$14,337,840 @ \$27,310
19	\$16,095,000 @ \$30,657	\$14,163,600 @ \$26,978
18	\$15,977,000 @ \$30,432	\$14,059,760 @ \$26,780
17	\$15,812,000 @ \$30,118	\$13,914,560 @ \$26,504
16	\$15,609,000 @ \$29,731	\$13,735,920 @ \$26,164
15	\$15,597,000 @ \$29,709	\$13,725,360 @ \$26,144
12	\$15,582,000 @ \$29,680	\$13,712,160 @ \$26,118
11	\$15,563,000 @ \$29,644	\$13,695,440 @ \$26,087
10	\$15,479,000 @ \$29,484	\$13,621,520 @ \$25,946
9	\$15,470,000 @ \$29,467	\$13,613,600 @ \$25,931
8	\$15,458,000 @ \$29,444	\$13,603,040 @ \$25,911
7	\$15,430,000 @ \$29,390	\$13,578,400 @ \$25,864
6	\$15,430,000 @ \$29,390	\$13,578,400 @ \$25,864
5	\$15,245,000 @ \$29,038	\$13,415,600 @ \$25,554
3	\$15,131,000 @ \$28,821	\$13,315,280 @ \$25,362

1B座F : 2房 357'/435'

樓層	訂價	折實價12%
36	\$12,577,000 @ \$28,913	\$11,067,760 @ \$25,443
35	\$12,539,000 @ \$28,825	\$11,034,320 @ \$25,366
33	\$12,502,000 @ \$28,740	\$11,001,760 @ \$25,291
32	\$12,464,000 @ \$28,653	\$10,968,320 @ \$25,215
31	\$12,427,000 @ \$28,568	\$10,935,760 @ \$25,140
30	\$12,390,000 @ \$28,483	\$10,903,200 @ \$25,065
29	\$12,353,000 @ \$28,398	\$10,870,640 @ \$24,990
27	\$12,228,000 @ \$28,110	\$10,760,640 @ \$24,737
26	\$12,191,000 @ \$28,025	\$10,728,080 @ \$24,662
25	\$12,155,000 @ \$27,943	\$10,696,400 @ \$24,589
23	\$12,118,000 @ \$27,857	\$10,663,840 @ \$24,515
22	\$12,082,000 @ \$27,775	\$10,632,160 @ \$24,442
21	\$12,046,000 @ \$27,692	\$10,600,480 @ \$24,369
20	\$12,010,000 @ \$27,609	\$10,568,800 @ \$24,296
19	\$11,974,000 @ \$27,526	\$10,537,120 @ \$24,223
18	\$11,938,000 @ \$27,444	\$10,505,440 @ \$24,150
17	\$11,867,000 @ \$27,280	\$10,442,960 @ \$24,007
16	\$11,817,000 @ \$27,166	\$10,398,960 @ \$23,906
15	\$11,768,000 @ \$27,053	\$10,355,840 @ \$23,807
12	\$11,733,000 @ \$26,972	\$10,325,040 @ \$23,736
11	\$11,698,000 @ \$26,892	\$10,294,240 @ \$23,665
10	\$11,663,000 @ \$26,811	\$10,263,440 @ \$23,594
9	\$11,628,000 @ \$26,731	\$10,232,640 @ \$23,523
8	\$11,593,000 @ \$26,651	\$10,201,840 @ \$23,453
7	\$11,524,000 @ \$26,492	\$10,141,120 @ \$23,313
6	\$11,487,000 @ \$26,407	\$10,108,560 @ \$23,238
5	\$11,453,000 @ \$26,329	\$10,078,640 @ \$23,169
3	\$9,808,000 @ \$27,473	\$8,631,040 @ \$24,177

1B座C : 2房 457'

樓層	訂價	折實價12%
31	\$14,406,000 @ \$31,523	\$12,677,280 @ \$27,740
30	\$14,363,000 @ \$31,429	\$12,639,440 @ \$27,657
26	\$14,149,000 @ \$30,961	\$12,451,120 @ \$27,245
25	\$14,107,000 @ \$30,869	\$12,414,160 @ \$27,164
23	\$14,065,000 @ \$30,777	\$12,377,200 @ \$27,084
22	\$14,023,000 @ \$30,685	\$12,340,240 @ \$27,003
21	\$13,967,000 @ \$30,562	\$12,290,960 @ \$26,895
20	\$13,939,000 @ \$30,501	\$12,266,320 @ \$26,841
19	\$13,897,000 @ \$30,409	\$12,229,360 @ \$26,760
18	\$13,856,000 @ \$30,319	\$12,193,280 @ \$26,681
17	\$13,773,000 @ \$30,138	\$12,120,240 @ \$26,521
15	\$13,674,000 @ \$29,921	\$12,033,120 @ \$26,331
12	\$13,633,000 @ \$29,832	\$11,997,040 @ \$26,252
11	\$13,326,000 @ \$29,160	\$11,726,880 @ \$25,661
10	\$13,043,000 @ \$28,540	\$11,477,840 @ \$25,116
9	\$12,876,000 @ \$28,175	\$11,330,880 @ \$24,794
8	\$12,710,000 @ \$27,812	\$11,184,800 @ \$24,474
7	\$12,547,000 @ \$27,455	\$11,041,360 @ \$24,161
6	\$12,253,000 @ \$26,812	\$10,782,640 @ \$23,594
5	\$12,216,000 @ \$26,731	\$10,750,080 @ \$23,523
3	\$12,180,000 @ \$26,652	\$10,718,400 @ \$23,454

紅色為最高售價、最高平均呎價；藍色為最低售價、最低平均呎價

以上的物業資料只供參考，一切以發展商最新公布為準，如有任何資料錯漏本網頁不會承擔任何責任。