

C5: 2房 430'		
樓層	訂價	折實價17.5%
10	\$7,866,700 @\$18,295	\$6,490,028 @\$15,093
9	\$7,421,400 @\$17,259	\$6,122,655 @\$14,239
8	\$7,406,600 @\$17,225	\$6,110,445 @\$14,210
7	\$7,384,500 @\$17,173	\$6,092,213 @\$14,168
6	\$7,369,700 @\$17,139	\$6,080,003 @\$14,140
5	\$7,355,000 @\$17,105	\$6,067,875 @\$14,111
3	\$7,325,600 @\$17,036	\$6,043,620 @\$14,055
2	\$7,281,600 @\$16,934	\$6,007,320 @\$13,971
1	\$7,237,900 @\$16,832	\$5,971,268 @\$13,887
C3: 2房 412'		
樓層	訂價	折實價17.5%
10	\$7,751,500 @\$18,814	\$6,394,988 @\$15,522
9	\$7,177,300 @\$17,421	\$5,921,273 @\$14,372
8	\$7,163,000 @\$17,386	\$5,909,475 @\$14,343
7	\$7,141,500 @\$17,334	\$5,891,738 @\$14,300
6	\$7,127,300 @\$17,299	\$5,880,023 @\$14,272
5	\$7,113,000 @\$17,265	\$5,868,225 @\$14,243
3	\$7,084,600 @\$17,196	\$5,844,795 @\$14,186
2	\$7,042,100 @\$17,092	\$5,809,733 @\$14,101
1	\$6,999,800 @\$16,990	\$5,774,835 @\$14,017
B7: 2房連多用途房 427/449'		
樓層	訂價	折實價17.5%
10	\$8,099,600 @\$18,039	\$6,682,170 @\$14,882
9	\$7,641,200 @\$17,018	\$6,303,990 @\$14,040
8	\$7,625,900 @\$16,984	\$6,291,368 @\$14,012
7	\$7,603,100 @\$16,933	\$6,272,558 @\$13,970
6	\$7,587,900 @\$16,900	\$6,260,018 @\$13,942
5	\$7,572,700 @\$16,866	\$6,247,478 @\$13,914
3	\$7,542,500 @\$16,798	\$6,222,563 @\$13,859
2	\$7,459,500 @\$16,614	\$6,154,088 @\$13,706
1	\$7,377,400 @\$16,431	\$6,086,355 @\$13,555
G	\$7,734,400 @\$18,113	\$6,380,880 @\$14,944
B1: 1房連多用途房 346/364'		
樓層	訂價	折實價17.5%
9	\$6,826,900 @\$18,755	\$5,632,193 @\$15,473
8	\$6,699,600 @\$18,405	\$5,527,170 @\$15,185
7	\$6,581,200 @\$18,080	\$5,429,490 @\$14,916
6	\$6,568,000 @\$18,044	\$5,418,600 @\$14,886
5	\$6,554,900 @\$18,008	\$5,407,793 @\$14,857
3	\$6,528,700 @\$17,936	\$5,386,178 @\$14,797
2	\$6,489,500 @\$17,828	\$5,353,838 @\$14,708
1	\$6,450,600 @\$17,721	\$5,321,745 @\$14,620
G	\$6,744,700 @\$19,493	\$5,564,378 @\$16,082

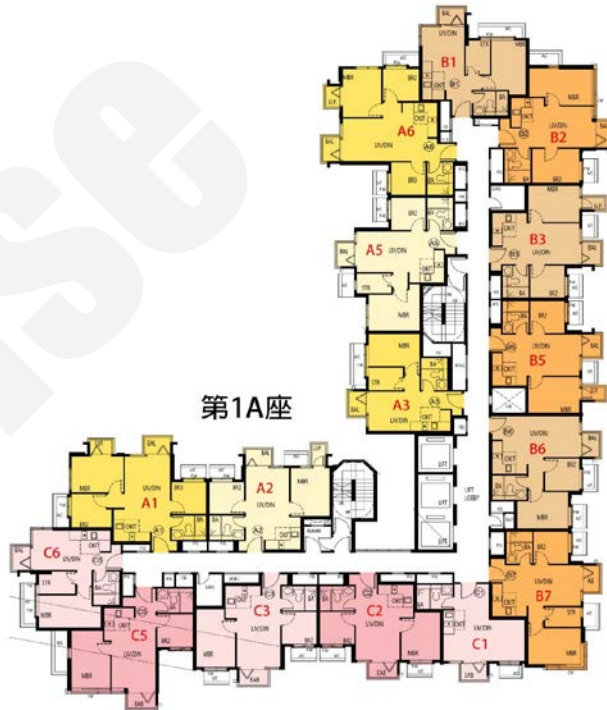

B6: 2房 392/413'		
樓層	訂價	折實價17.5%
10	\$7,724,400 @\$18,703	\$6,372,630 @\$15,430
9	\$7,287,100 @\$17,644	\$6,011,858 @\$14,557
8	\$7,272,600 @\$17,609	\$5,999,895 @\$14,528
7	\$7,250,800 @\$17,556	\$5,981,910 @\$14,484
6	\$7,236,400 @\$17,522	\$5,970,030 @\$14,455
5	\$7,113,900 @\$17,225	\$5,868,968 @\$14,211
3	\$7,052,700 @\$17,077	\$5,818,478 @\$14,088
2	\$6,954,700 @\$16,839	\$5,737,623 @\$13,893
1	\$6,773,400 @\$16,400	\$5,588,055 @\$13,530
G	\$7,219,700 @\$18,418	\$5,956,253 @\$15,195

B5: 2房 366/403'		
樓層	訂價	折實價17.5%
10	\$7,738,300 @\$19,202	\$6,384,098 @\$15,841
9	\$7,165,100 @\$17,779	\$5,911,208 @\$14,668
8	\$7,150,800 @\$17,744	\$5,899,410 @\$14,639
7	\$7,129,400 @\$17,691	\$5,881,755 @\$14,595
6	\$7,115,200 @\$17,656	\$5,870,040 @\$14,566
5	\$6,995,400 @\$17,358	\$5,771,205 @\$14,321
3	\$6,949,500 @\$17,244	\$5,733,338 @\$14,227
2	\$6,881,300 @\$17,075	\$5,677,073 @\$14,087
1	\$6,764,200 @\$16,785	\$5,580,465 @\$13,847
G	\$7,197,300 @\$19,665	\$5,937,773 @\$16,223

B1: 2房 405'		
樓層	訂價	折實價17.5%
2	\$7,015,400 @\$17,322	\$5,787,705 @\$14,291

A6: 3房 512/761'		
樓層	訂價	折實價17.5%
10	\$15,035,900 @\$19,758	\$12,404,618 @\$16,300
9	\$9,172,100 @\$17,914	\$7,566,983 @\$14,779
8	\$9,001,100 @\$17,580	\$7,425,908 @\$14,504
7	\$8,841,900 @\$17,269	\$7,294,568 @\$14,247
6	\$8,824,300 @\$17,235	\$7,280,048 @\$14,219
5	\$8,806,700 @\$17,201	\$7,265,528 @\$14,190
3	\$8,771,400 @\$17,132	\$7,236,405 @\$14,134
2	\$8,718,800 @\$17,029	\$7,193,010 @\$14,049
1	\$8,652,200 @\$16,899	\$7,138,065 @\$13,942

A5: 2房連多用途房 450'		
樓層	訂價	折實價17.5%
10	\$8,844,600 @\$19,655	\$7,296,795 @\$16,215
9	\$8,189,400 @\$18,199	\$6,756,255 @\$15,014
8	\$8,036,700 @\$17,859	\$6,630,278 @\$14,734
7	\$7,894,600 @\$17,544	\$6,513,045 @\$14,473
6	\$7,878,800 @\$17,508	\$6,500,010 @\$14,444
5	\$7,863,100 @\$17,474	\$6,487,058 @\$14,416
3	\$7,831,600 @\$17,404	\$6,461,070 @\$14,358
2	\$7,784,600 @\$17,299	\$6,422,295 @\$14,272
1	\$7,737,900 @\$17,195	\$6,383,768 @\$14,186

A1: 3房 495/722'		
樓層	訂價	折實價17.5%
10	\$14,090,100 @\$19,515	\$11,624,333 @\$16,100
9	\$9,197,300 @\$18,580	\$7,587,773 @\$15,329
8	\$9,025,900 @\$18,234	\$7,446,368 @\$15,043
7	\$8,866,300 @\$17,912	\$7,314,698 @\$14,777
6	\$8,848,600 @\$17,876	\$7,300,095 @\$14,748
5	\$8,830,900 @\$17,840	\$7,285,493 @\$14,718
3	\$8,795,500 @\$17,769	\$7,256,288 @\$14,659
2	\$8,742,800 @\$17,662	\$7,212,810 @\$14,571
1	\$8,690,300 @\$17,556	\$7,169,498 @\$14,484

A3: 1房連多用途房 366'		
樓層	訂價	折實價17.5%
10	\$7,347,800 @\$20,076	\$6,061,935 @\$16,563
9	\$6,803,500 @\$18,589	\$5,612,888 @\$15,336
8	\$6,676,600 @\$18,242	\$5,508,195 @\$15,050
7	\$6,558,600 @\$17,920	\$5,410,845 @\$14,784
6	\$6,545,500 @\$17,884	\$5,400,038 @\$14,754
5	\$6,532,400 @\$17,848	\$5,389,230 @\$14,725
3	\$6,506,300 @\$17,777	\$5,367,698 @\$14,666
2	\$6,467,200 @\$17,670	\$5,335,440 @\$14,578
1	\$6,428,400 @\$17,564	\$5,303,430 @\$14,490

A2: 2房 409'		
樓層	訂價	折實價17.5%
10	\$8,427,000 @\$20,604	\$6,952,275 @\$16,998
9	\$7,950,000 @\$19,438	\$6,558,750 @\$16,036
8	\$7,801,700 @\$19,075	\$6,436,403 @\$15,737
7	\$7,663,800 @\$18,738	\$6,322,635 @\$15,459
6	\$7,648,500 @\$18,700	\$6,310,013 @\$15,428
5	\$7,633,200 @\$18,663	\$6,297,390 @\$15,397
3	\$7,602,700 @\$18,589	\$6,272,228 @\$15,336
2	\$7,557,000 @\$18,477	\$6,234,525 @\$15,243
1	\$7,511,700 @\$18,366	\$6,197,153 @\$15,152

C6: 1房連多用途房 363'		
樓層	訂價	折實價17.5%
9	\$6,870,400 @\$18,927	\$5,668,080 @\$15,615
8	\$6,709,400 @\$18,483	\$5,535,255 @\$15,249
7	\$6,558,600 @\$18,068	\$5,410,845 @\$14,906
6	\$6,545,500 @\$18,032	\$5,400,038 @\$14,876
5	\$6,532,400 @\$17,996	\$5,389,230 @\$14,846
3	\$6,506,200 @\$17,923	\$5,367,615 @\$14,787
2	\$6,491,200 @\$17,882	\$5,355,240 @\$14,753
1	\$6,428,400 @\$17,709	\$5,303,430 @\$14,610

紅色為最高售價、最高平均呎價；藍色為最低售價、最低平均呎價

Wetland Seasons Bay 2期

價單1及2號

以最高17.5%折扣計算

制作日期: 2021-11-8



**C2 : 2房 376'/413'**

樓層	訂價	折實價17.5%
10	\$7,962,500 @\$19,280	\$6,569,063 @\$15,906
9	\$7,372,700 @\$17,852	\$6,082,478 @\$14,728
8	\$7,357,900 @\$17,816	\$6,070,268 @\$14,698
7	\$7,335,900 @\$17,762	\$6,052,118 @\$14,654
6	\$7,321,300 @\$17,727	\$6,040,073 @\$14,625
5	\$7,306,700 @\$17,692	\$6,028,028 @\$14,596
3	\$7,204,400 @\$17,444	\$5,943,630 @\$14,391
2	\$7,089,100 @\$17,165	\$5,848,508 @\$14,161
1	\$7,176,800 @\$19,087	\$5,920,860 @\$15,747

**C1 : 開放式 245'/267'**

樓層	訂價	折實價17.5%
10	\$5,774,000 @\$21,625	\$4,763,550 @\$17,841
9	\$5,346,300 @\$20,024	\$4,410,698 @\$16,519
8	\$5,335,700 @\$19,984	\$4,401,953 @\$16,487
7	\$5,319,700 @\$19,924	\$4,388,753 @\$16,437
6	\$5,309,100 @\$19,884	\$4,380,008 @\$16,405
5	\$5,298,500 @\$19,845	\$4,371,263 @\$16,372
3	\$5,224,300 @\$19,567	\$4,310,048 @\$16,143
2	\$5,137,000 @\$19,240	\$4,238,025 @\$15,873
1	\$5,269,100 @\$21,507	\$4,347,008 @\$17,743

**B6 : 2房 385'/423'**

樓層	訂價	折實價17.5%
10	\$8,180,600 @\$19,339	\$6,748,995 @\$15,955
9	\$7,717,500 @\$18,245	\$6,366,938 @\$15,052
8	\$7,686,800 @\$18,172	\$6,341,610 @\$14,992
7	\$7,663,800 @\$18,118	\$6,322,635 @\$14,947
6	\$7,648,500 @\$18,082	\$6,310,013 @\$14,917
5	\$7,633,200 @\$18,045	\$6,297,390 @\$14,887
3	\$7,602,700 @\$17,973	\$6,272,228 @\$14,828
2	\$7,557,000 @\$17,865	\$6,234,525 @\$14,739
1	\$7,624,400 @\$19,804	\$6,290,130 @\$16,338

**B3 : 2房 368'/405'**

樓層	訂價	折實價17.5%
10	\$8,334,900 @\$20,580	\$6,876,293 @\$16,979
9	\$7,717,500 @\$19,056	\$6,366,938 @\$15,721
8	\$7,686,800 @\$18,980	\$6,341,610 @\$15,658
7	\$7,663,800 @\$18,923	\$6,322,635 @\$15,611
6	\$7,648,500 @\$18,885	\$6,310,013 @\$15,580
5	\$7,633,200 @\$18,847	\$6,297,390 @\$15,549
3	\$7,602,700 @\$18,772	\$6,272,228 @\$15,487
2	\$7,557,100 @\$18,660	\$6,234,608 @\$15,394
1	\$7,628,900 @\$20,731	\$6,293,843 @\$17,103

**C3 : 2房 428'**

樓層	訂價	折實價17.5%
2	\$7,112,500 @\$16,618	\$5,867,813 @\$13,710

**B7 : 2房連多用途房 441'**

樓層	訂價	折實價17.5%
2	\$7,748,700 @\$17,571	\$6,392,678 @\$14,498

**B : 4房連套房 773'**

樓層	訂價	折實價17.5%
1	\$12,215,800 @\$15,803	\$10,078,035 @\$13,038

**A : 4房連套房 795'**

樓層	訂價	折實價17.5%
1	\$12,623,400 @\$15,878	\$10,414,305 @\$13,100

別墅RV2



紅色為最高售價、最高平均呎價；藍色為最低售價、最低平均呎價

新盤價單表

Wetland Seasons Bay 2期

價單1及2號

以最高17.5%折扣計算

制作日期: 2021-11-8

B :4房連套房 773'		
樓層	訂價	折實價17.5%
1	\$12,215,800 @\$15,803	\$10,078,035 @\$13,038
A :4房連套房 795'		
樓層	訂價	折實價17.5%
1	\$12,623,400 @\$15,878	\$10,414,305 @\$13,100

別墅RV3

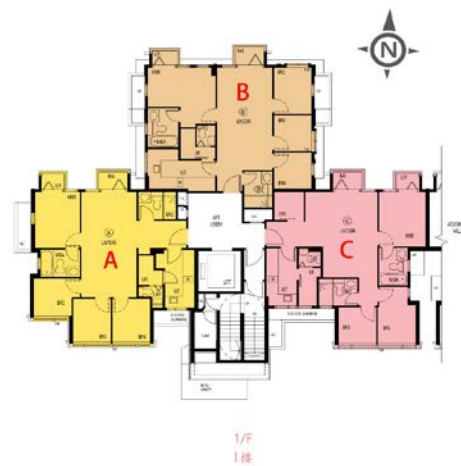

B :4房連套房 773'		
樓層	訂價	折實價17.5%
1	\$12,262,700 @\$15,864	\$10,116,728 @\$13,088
A :4房連套房 795'		
樓層	訂價	折實價17.5%
1	\$12,623,400 @\$15,878	\$10,414,305 @\$13,100

別墅RV5

