

C: 3房 504'/1755'		
樓層	訂價	折實價11.25%
2	\$10,454,000 @\$20,742	\$9,277,925 @\$18,409
3	\$10,592,000 @\$21,016	\$9,400,400 @\$18,652
5	\$10,731,000 @\$21,292	\$9,523,763 @\$18,896
6	\$10,763,000 @\$21,355	\$9,552,163 @\$18,953
7	\$10,795,000 @\$21,419	\$9,580,563 @\$19,009
8	\$10,969,000 @\$21,764	\$9,734,988 @\$19,315
9	\$11,002,000 @\$21,829	\$9,764,275 @\$19,374
10	\$11,034,000 @\$21,893	\$9,792,675 @\$19,430
11	\$11,068,000 @\$21,960	\$9,822,850 @\$19,490
12	\$11,101,000 @\$22,026	\$9,852,138 @\$19,548
15	\$11,135,000 @\$22,093	\$9,882,313 @\$19,608
16	\$11,167,000 @\$22,157	\$9,910,713 @\$19,664
17	Sold	

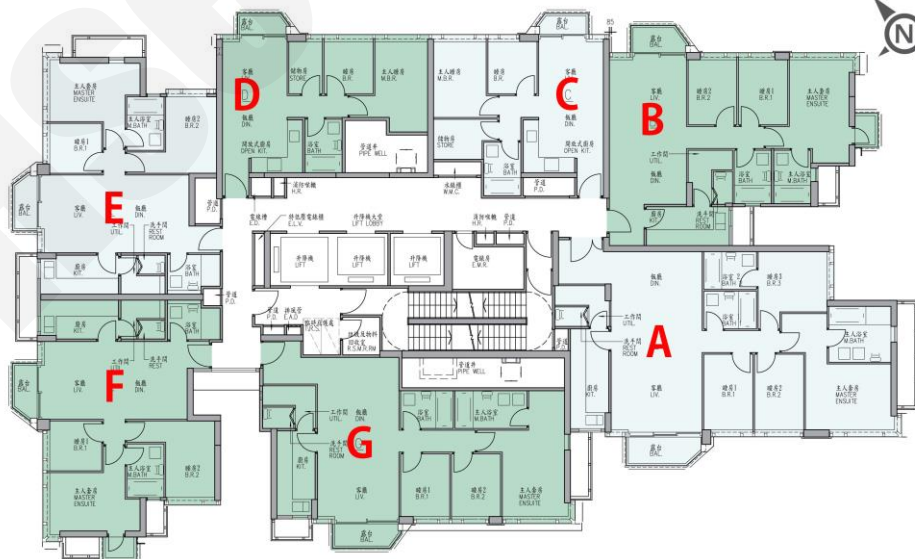

D: 3房 520'/525'		
樓層	訂價	折實價11.25%
2	\$10,890,000 @\$20,743	\$9,664,875 @\$18,409
3	\$10,928,000 @\$21,015	\$9,698,600 @\$18,651
5	\$11,072,000 @\$21,292	\$9,826,400 @\$18,897
6	\$11,105,000 @\$21,356	\$9,855,688 @\$18,953
7	\$11,138,000 @\$21,419	\$9,884,975 @\$19,010
8	Sold	
9	\$11,351,000 @\$21,829	\$10,074,013 @\$19,373
10	\$11,385,000 @\$21,894	\$10,104,188 @\$19,431
11	\$11,420,000 @\$21,962	\$10,135,250 @\$19,491
12	\$11,454,000 @\$22,027	\$10,165,425 @\$19,549
15	\$11,487,000 @\$22,090	\$10,194,713 @\$19,605
16	\$11,522,000 @\$22,158	\$10,225,775 @\$19,665